

A - A - Scara 1:7.5

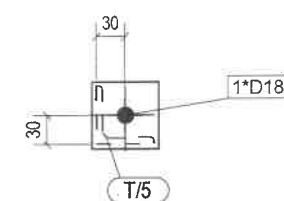

B - B - Scara 1:7.5

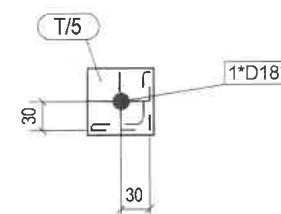

C - C - Scara 1:7.5

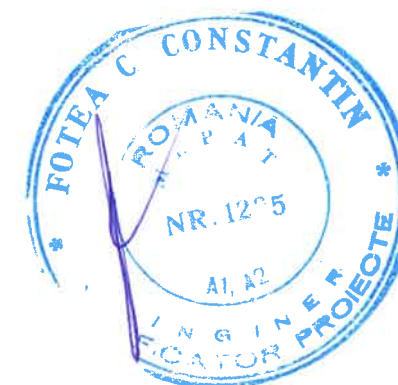

LISTA MATERIALE PENTRU 1 BUC. ANSAMBLUL POZ.			CF/1	5.8	kg		3	BUCATI DE EXECUTAT	
Pozitia	Denumire	Profil	Material	Bucati	Lungime [mm]	Suprafata [m2]	Masa [kg]		
P/26	CF	L60*6	S235JR	1	954	0.22	5.2		
T/5	PLACA DE CAPAT	PL8*70	S235JR	2	70	0.01	0.3		
						Total	0.25	5.8	

BENEFICIAR:				PROIECT:			
ADMINISTRATIA COMERCIALA SECTOR 6				PIATA VALEA IALOMITEI			
PROIECTANT REZISTENTA: SC LGC CONCEPT DESIGN SRL							
DENUMIRE PLANSA:				PLAN UZINARE ANSAMBLUL: CF/1			
PROIECTANT: ing. Stefan Neacsu				SCARA: 1:7.5		Nr. Crt: CF/1	

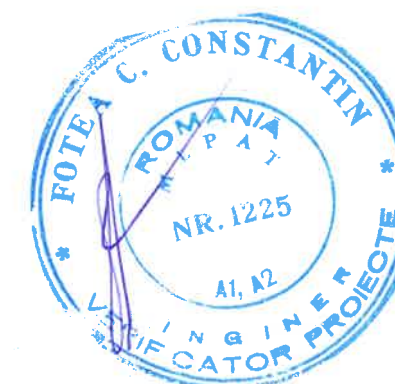
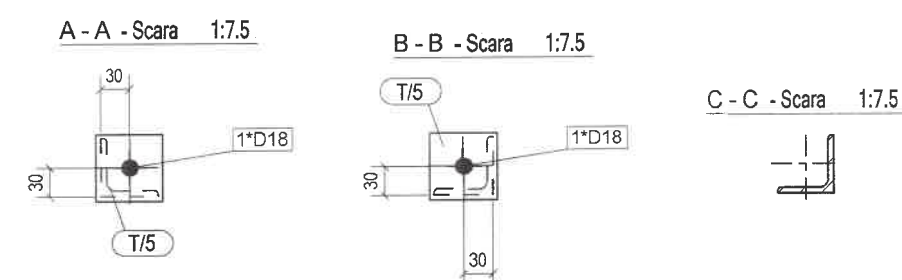
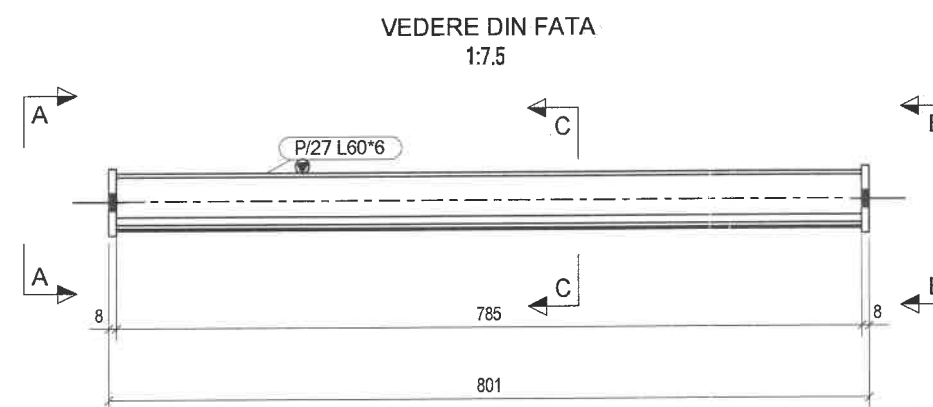
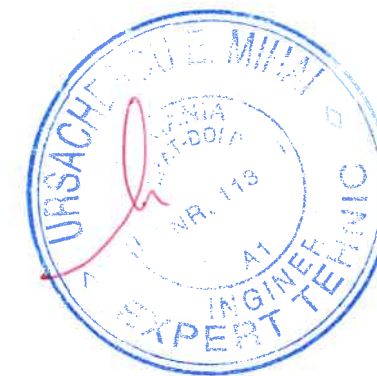

LISTA MATERIALE PENTRU 1 BUC. ANSAMBLUL POZ. CF/2			4.9	kg	4	BUCATI DE EXECUTAT	
Pozitia	Denumire	Profil	Material	Bucati	Lungime [mm]	Suprafata [m2]	Masa [kg]
P/27	CF	L60*6	S235JR	1	785	0.18	4.3
T/5	PLACA DE CAPAT	PL8*70	S235JR	2	70	0.01	0.3
Total						0.21	4.9

BENEFICIAR: ADMINISTRATIA COMERCIALA SECTOR 6			PROIECT: PIATA VALEA IALOMITEI	
PROIECTANT REZISTENTA: SC LGC CONCEPT DESIGN SRL				
DENUMIRE PLANSĂ: PLAN UZINARE ANSAMBLUL: CF/2				
PROIECTANT: Ing. Stefan Neacsu			SCARA: 1:7.5	Nr. Crt. CF/2

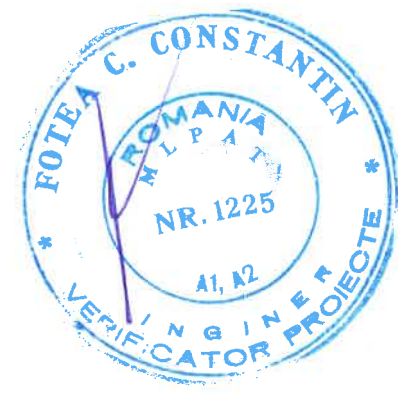
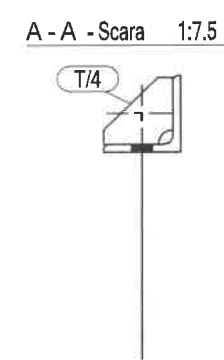
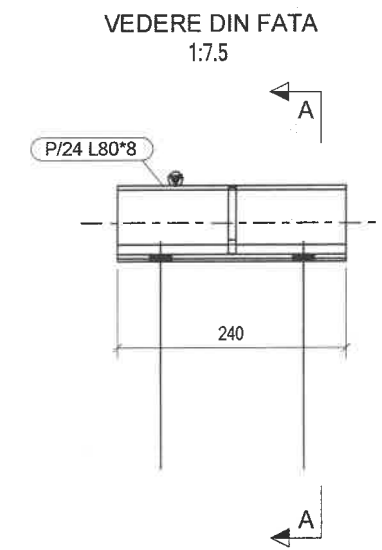
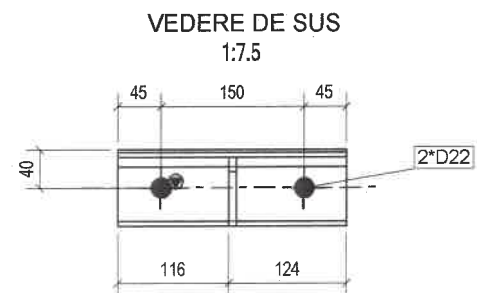

LISTA MATERIALE PENTRU 1 BUC. ANSAMBLUL POZ.			SV/1	2.5	kg	7	BUCATI DE EXECUTA	
Pozitia	Denumire	Profil	Material	Bucati	Lungime [mm]	Suprafata [m2]	Masa [kg]	
P/24	SUPPORT VANG	L80*8	S235JR	1	240	0.07	2.3	
T/4	RIGIDIZARE	PL8*70	S235JR	1	72	0.01	0.2	
Total						0.08	2.5	

BENEFICIAR:		PROIECT:	
ADMINISTRATIA COMERCIALA SECTOR 6		PIATA VALEA IALOMITEI	
PROIECTANT REZISTENTA: SC LGC CONCEPT DESIGN SRL			
DENUMIRE PLANSĂ:		PLAN UZINARE ANSAMBLUL: SV/1	
PROIECTANT: ing. Stefan Neacsu		SCARA: 1:7.5	Nr. Crt SV/1

VEDERE DE SUS
1:7.5

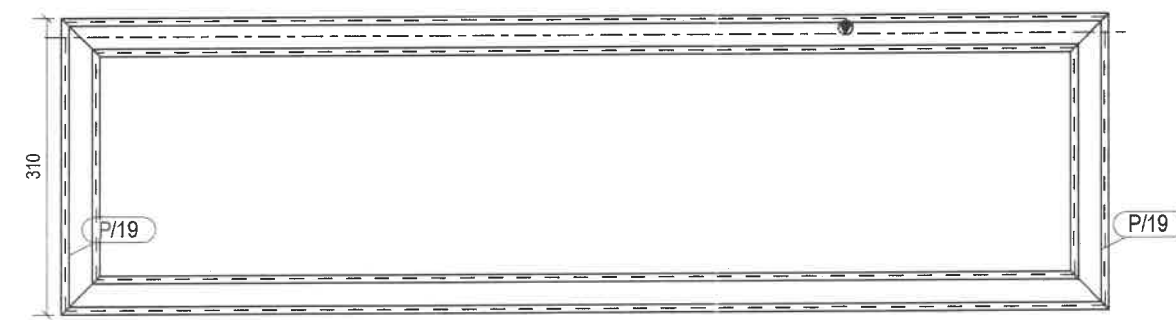

VEDERE DIN FATA
1:7.5

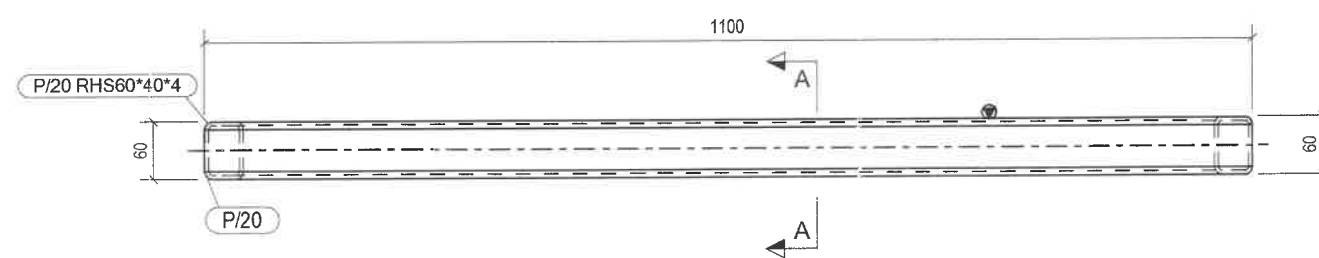

A - A - Scara 1:7.5

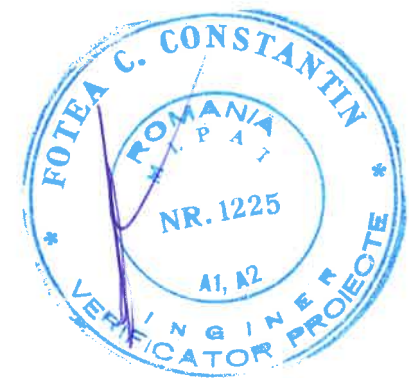

LISTA MATERIALE PENTRU 1 BUC. ANSAMBLUL POZ.			TR/1	16.1	kg	24	BUCATI DE EXECUTA	
Pozitia	Denumire	Profil	Material	Bucati	Lungime [mm]	Suprafata [m2]	Masa [kg]	
P/20	TREAPTA	RHS60*40*4	S235JR	2	1100	0.21	6.3	
P/19	TREAPTA	RHS60*40*4	S235JR	2	310	0.06	1.8	
Total						0.54	16.1	

BENEFICIAR:			PROIECT:	
ADMINISTRATIA COMERCIALA SECTOR 6			PIATA VALEA IALOMITEI	
PROIECTANT REZISTENTA: SC LGC CONCEPT DESIGN SRL				
DENUMIRE PLANSĂ:			PLAN UZINARE ANSAMBLUL: TR/1	
PROIECTANT: ing. Stefan Neacsu			SCARA: 1:7.5	
			Nr. Crt. TR/1	

VEDERE DE SUS
1:7.5

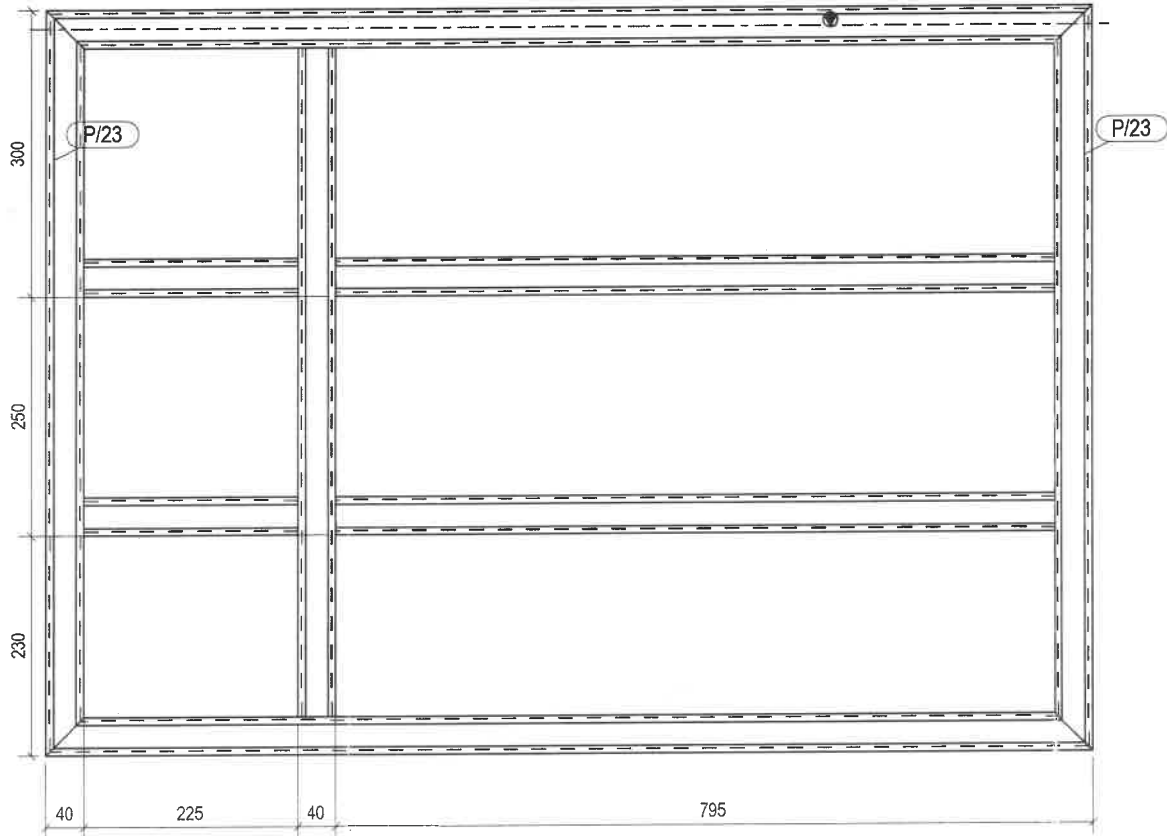

VEDERE DIN FATA
1:7.5

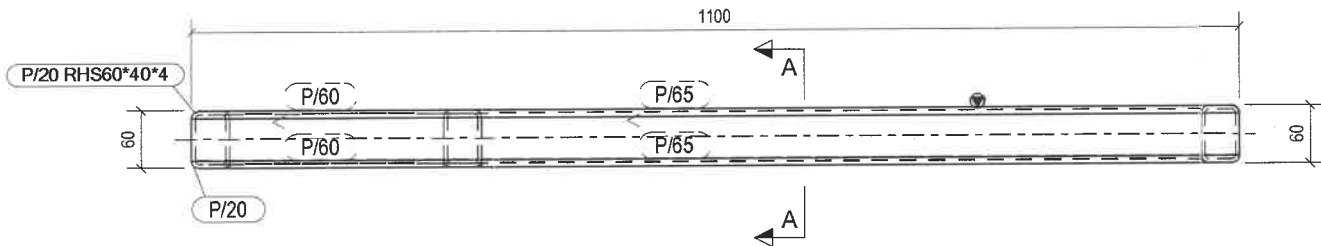

A - A - Scara 1:7.5

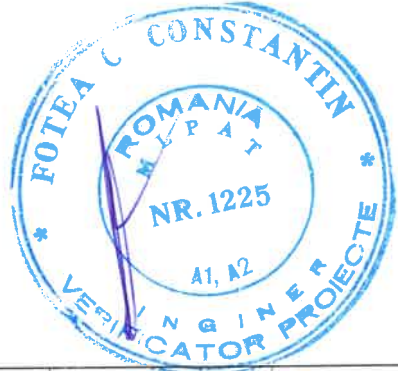
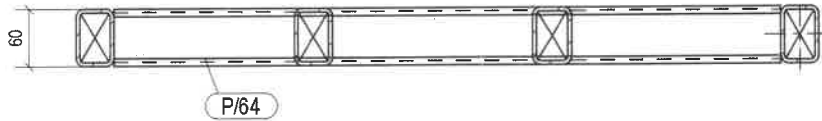

LISTA MATERIALE PENTRU 1 BUC. ANSAMBLUL POZ. TR/2				36.7	kg	1	BUCATI DE EXECUTAT	
Pozitia	Denumire	Profil	Material	Bucati	Lungime [mm]	Suprafata [m2]	Masa [kg]	
P/20	TREAPTA	RHS60*40*4	S235JR	2	1100	0.21	6.3	
P/23	TREAPTA	RHS60*40*4	S235JR	2	780	0.15	4.5	
P/65	TREAPTA	RHS60*40*4	S235JR	2	755	0.14	4.3	
P/64	TREAPTA	RHS60*40*4	S235JR	1	700	0.13	4.0	
P/60	TREAPTA	RHS60*40*4	S235JR	2	225	0.04	1.3	
Total						1.23	36.7	

BENEFICIAR: ADMINISTRATIA COMERCIALA SECTOR 6			PROIECT: PIATA VALEA IALOMITEI		
PROIECTANT REZISTENTA: SC LGC CONCEPT DESIGN SRL					
DENUMIRE PLANSĂ: PLAN UZINARE ANSAMBLUL: TR/2					
PROIECTANT: ing. Stefan Neacsu			SCARA: 1:7.5		Nr. Crt. TR/2

VEDERE DE SUS
1:7.5

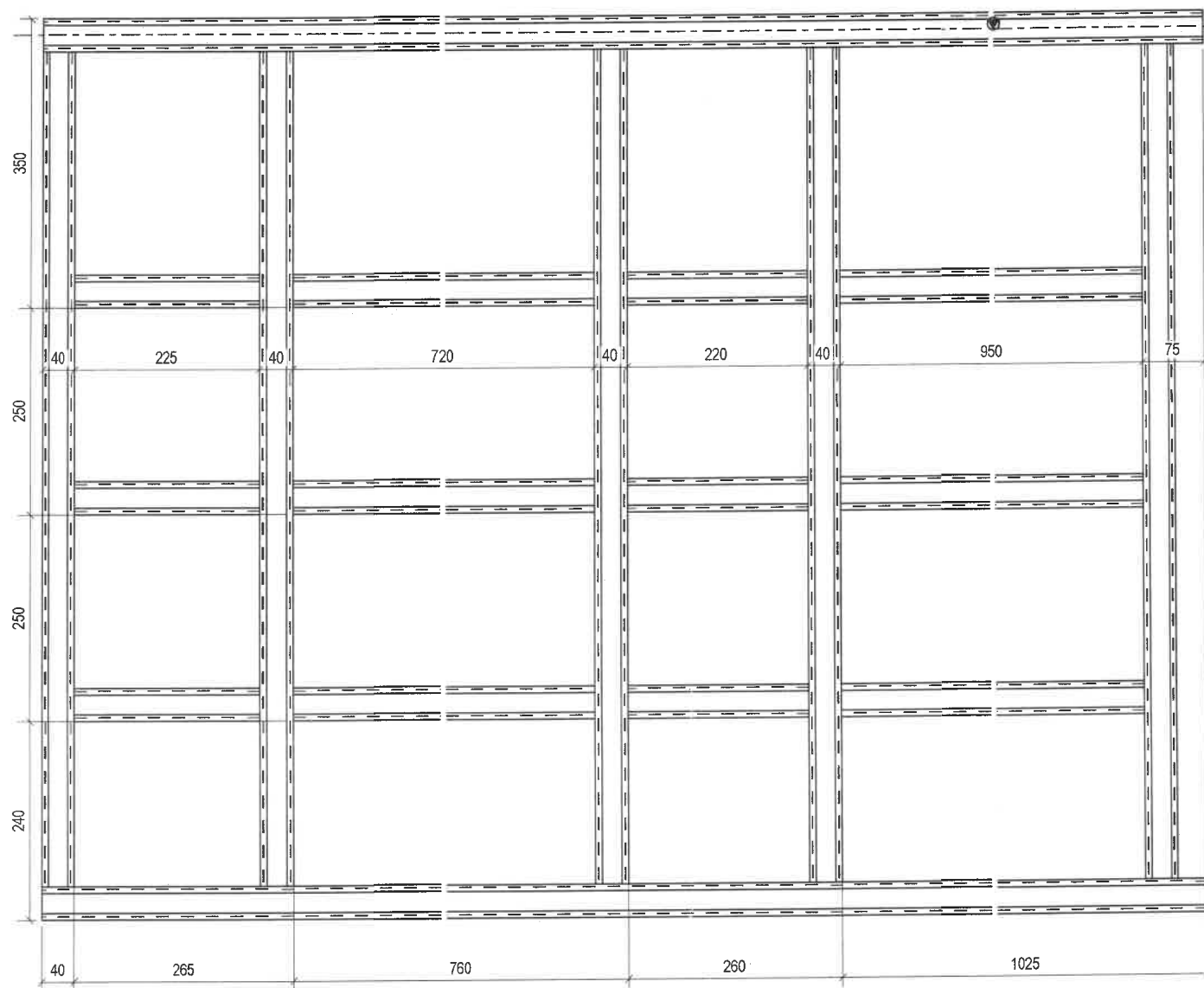

VEDERE DIN FATA
1:7.5

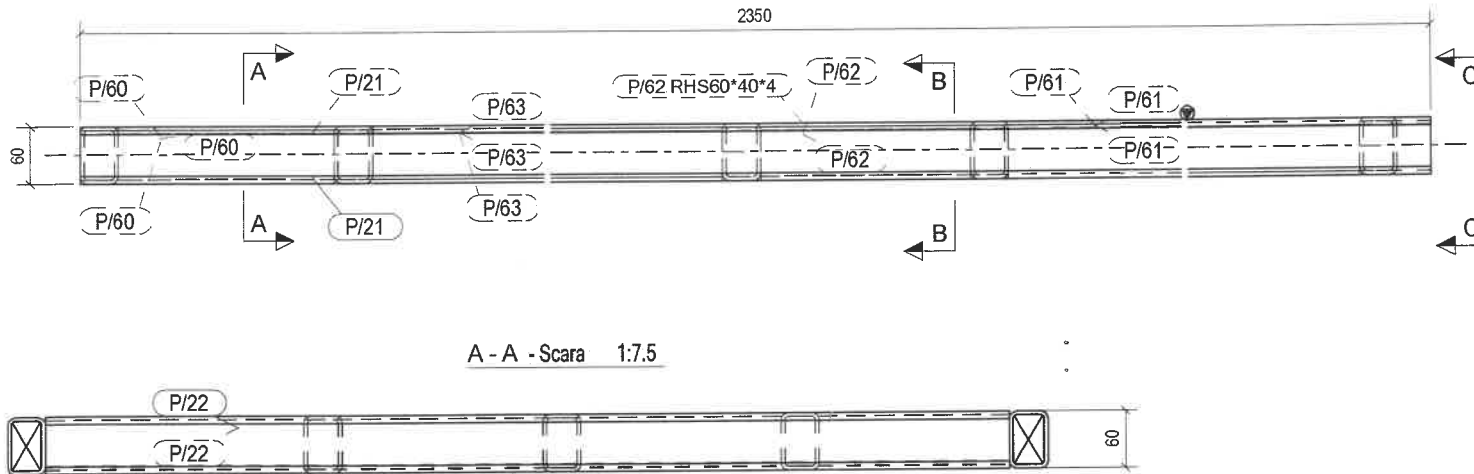

B - B - Scara 1:7.5

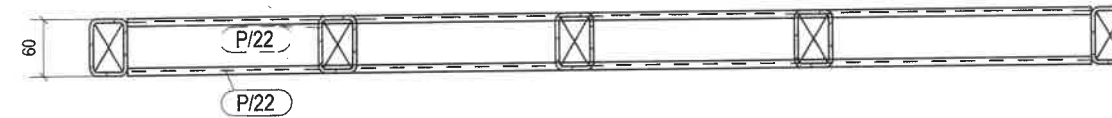

C - C - Scara 1:7.5

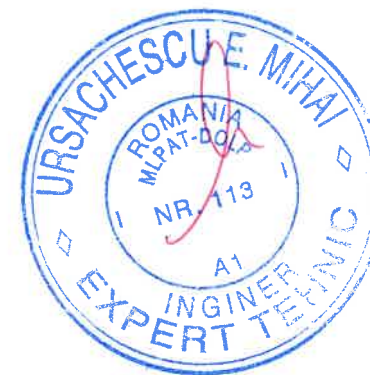
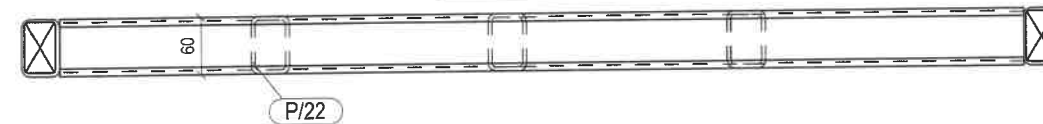

LISTA MATERIALE PENTRU 1 BUC. ANSAMBLUL POZ. TR/4				92.0	kg	2	BUCATI DE EXECUTA	
Pozitia	Denumire	Profil	Material	Bucati	Lungime [mm]	Suprafata [m2]	Masa [k]	
P/21	TREAPTA	RHS60*40*4	S235JR	2	2350	0.45	13.4	
P/22	TREAPTA	RHS60*40*4	S235JR	5	1010	0.19	5.8	
P/61	TREAPTA	RHS60*40*4	S235JR	3	950	0.18	5.4	
P/63	TREAPTA	RHS60*40*4	S235JR	3	720	0.14	4.1	
P/60	TREAPTA	RHS60*40*4	S235JR	3	225	0.04	1.3	
P/62	TREAPTA	RHS60*40*4	S235JR	3	220	0.04	1.3	
				Total		3.07	92.0	

BENEFICIAR:			PROIECT:	
ADMINISTRATIA COMERCIALA SECTOR 6			PIATA VALEA IALOMITEI	
PROIECTANT REZISTENTA: SC LGC CONCEPT DESIGN SRL				
DENUMIRE PLANSĂ:			PLAN UZINARE ANSAMBLUL: TR/4	
PROIECTANT: ing. Stefan Neacsu			SCARA: 1:7.5	
			Nr. Crt. TR/4	

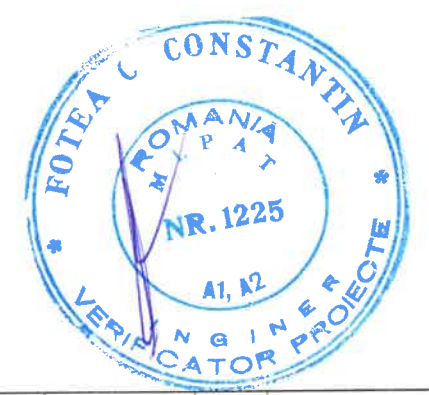
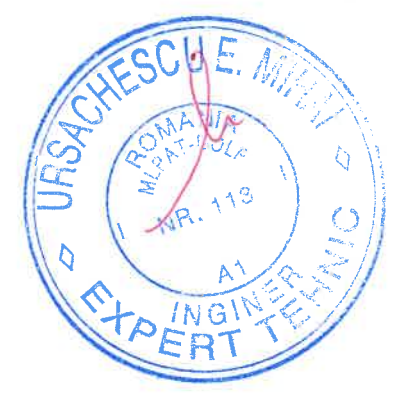
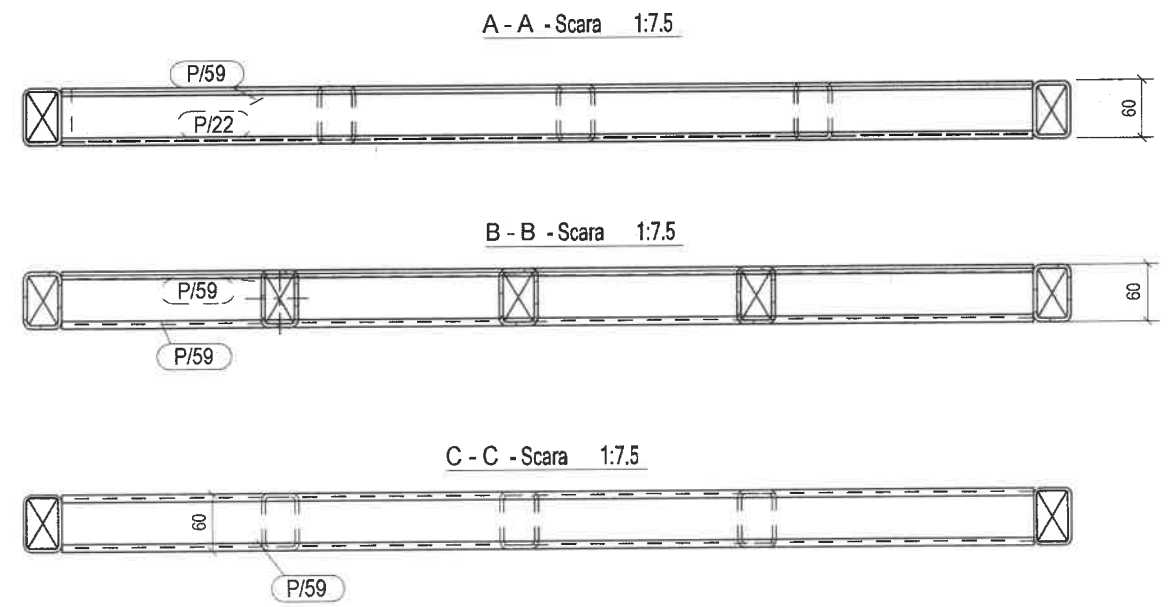
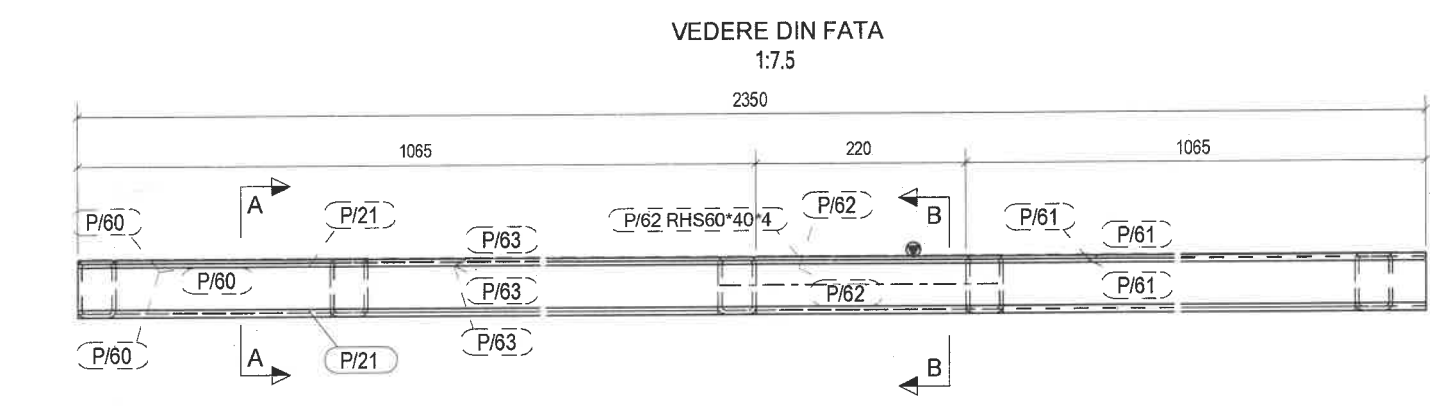
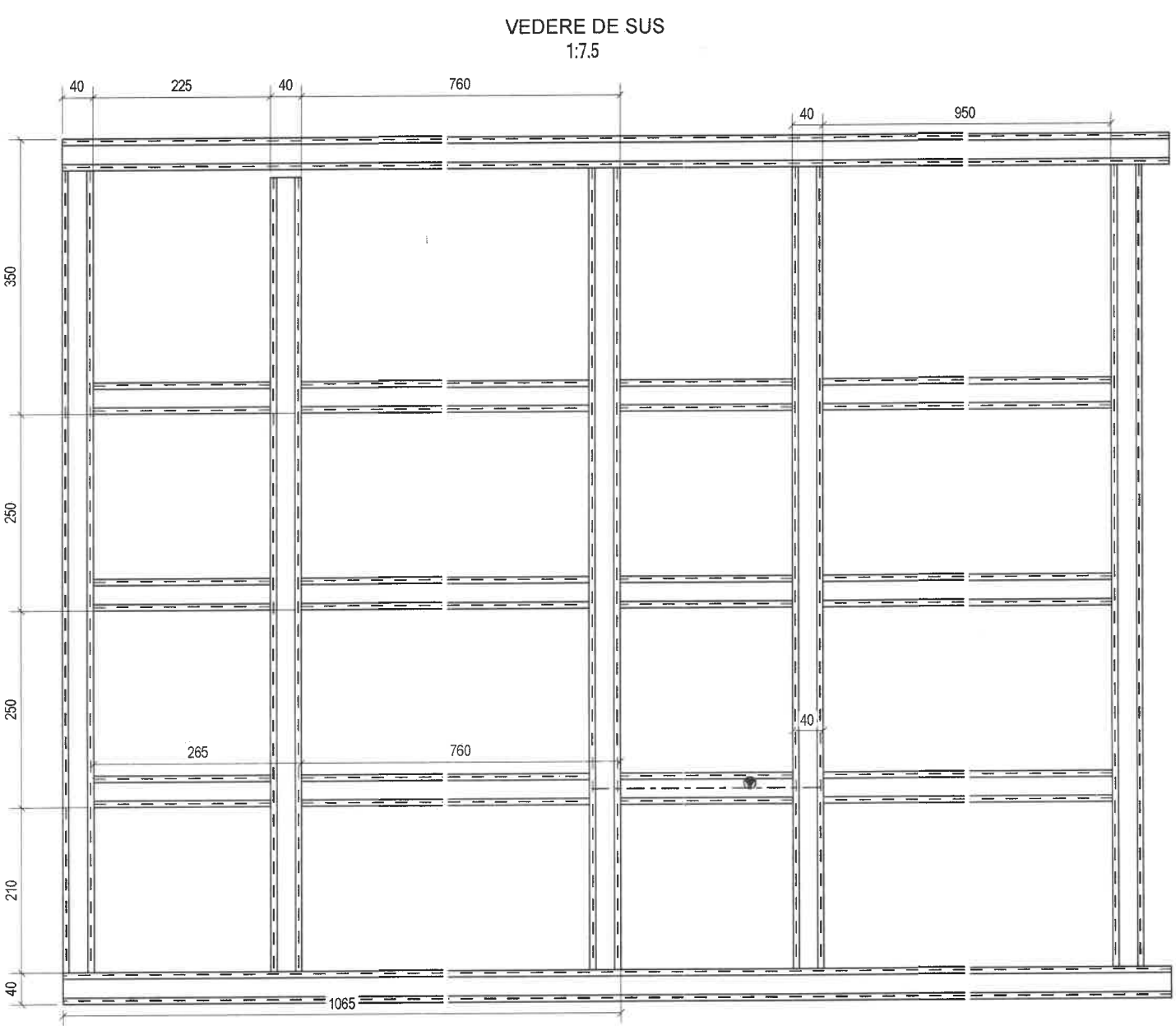

LISTA MATERIALE PENTRU 1 BUC. ANSAMBLUL POZ. TR/5				92.2	kg	1	BUCATI DE EXECUTA	
Pozitia	Denumire	Profil	Material	Bucati	Lungime [mm]	Suprafata [m2]	Masa [kg]	
P/21	TREAPTA	RHS60*40*4	S235JR	2	2350	0.45	13.4	
P/22	TREAPTA	RHS60*40*4	S235JR	1	1010	0.19	5.8	
P/59	TREAPTA	RHS60*40*4	S235JR	4	1020	0.19	5.8	
P/61	TREAPTA	RHS60*40*4	S235JR	3	950	0.18	5.4	
P/63	TREAPTA	RHS60*40*4	S235JR	3	720	0.14	4.1	
P/60	TREAPTA	RHS60*40*4	S235JR	3	225	0.04	1.3	
P/62	TREAPTA	RHS60*40*4	S235JR	3	220	0.04	1.3	
				Total		3.08	92.2	

BENEFICIAR: ADMINISTRATIA COMERCIALA SECTOR 6			PROIECT: PIATA VALEA IALOMITEI	
PROIECTANT REZISTENTA: SC LGC CONCEPT DESIGN SRL				
DENUMIRE PLANSA: PLAN UZINARE ANSAMBLUL: TR/5				
PROIECTANT: Ing. Stefan Neacsu			SCARA: 1:7.5	Nr. Crt TR/5

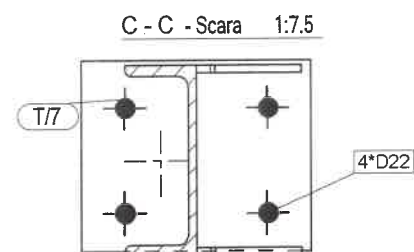
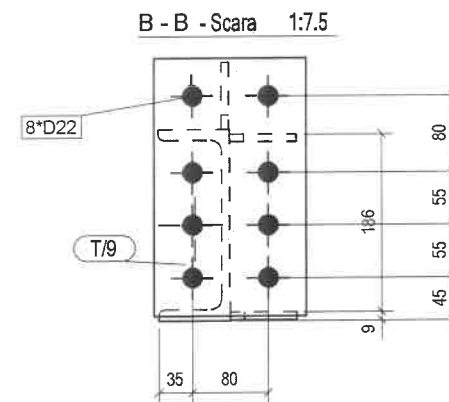
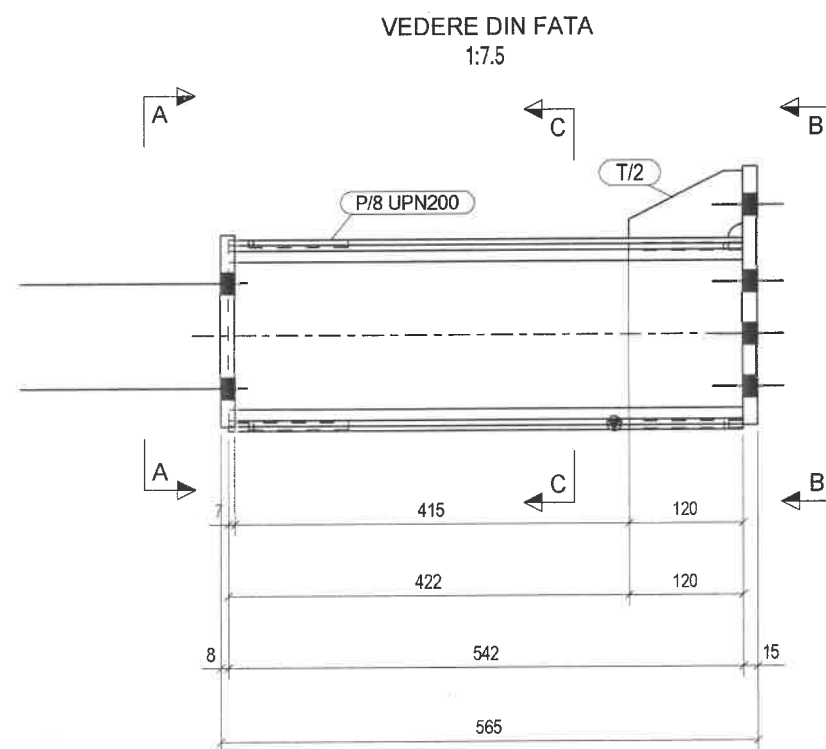
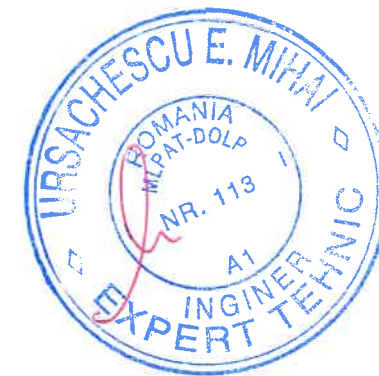
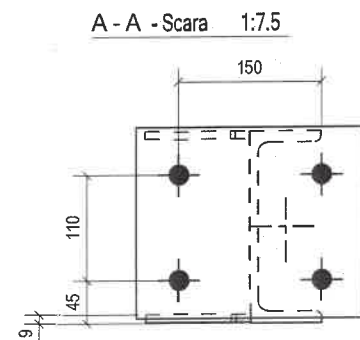
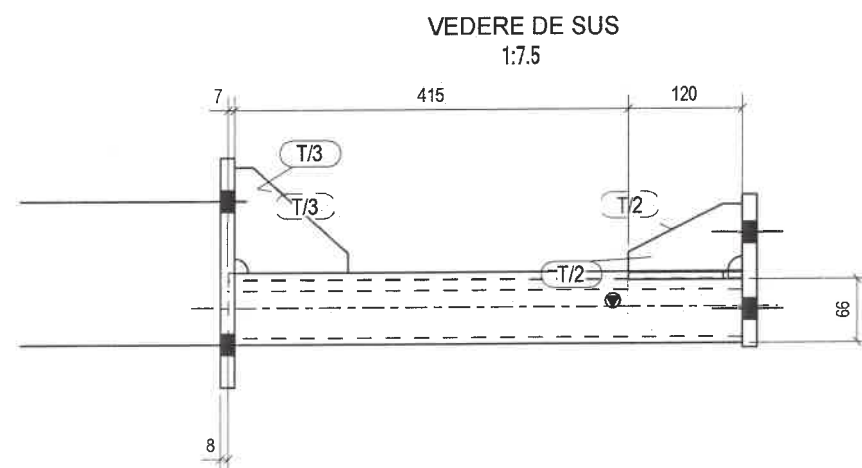

LISTA MATERIALE PENTRU 1 BUC. ANSAMBLUL POZ.			VS/2	26.6	kg	2	BUCATI DE EXECUTAT	
Pozitia	Denumire	Profil	Material	Bucati	Lungime [mm]	Suprafata [m2]	Masa [kg]	
P/8	VANG SCARA	UPN200	S235JR	1	542	0.36	13.7	
T/7	PLACA DE CAPAT	PL15*240	S235JR	1	200	0.11	5.7	
T/9	PLACA DE CAPAT	PL15*160	S235JR	1	270	0.10	5.1	
T/3	RIGIDIZARE	PL8*110	S235JR	2	120	0.02	0.5	
T/2	RIGIDIZARE	PL8*70	S235JR	3	120	0.01	0.4	
Total						0.65	26.6	

BENEFICIAR:	ADMINISTRATIA COMERCIALA SECTOR 6	PROIECT:	PIATA VALEA IALOMITEI
PROIECTANT REZISTENTA:	SC LGC CONCEPT DESIGN SRL		
DENUMIRE PLANS:	PLAN UZINARE ANSAMBLUL: VS/2		
PROIECTANT:	ing. Stefan Neacsu	SCARA: 1:7.5	Nr. Crt: VS/2

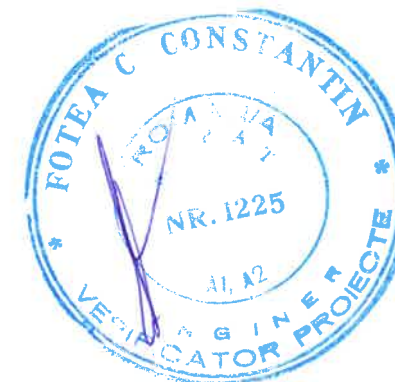
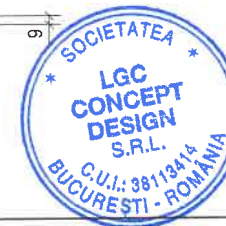
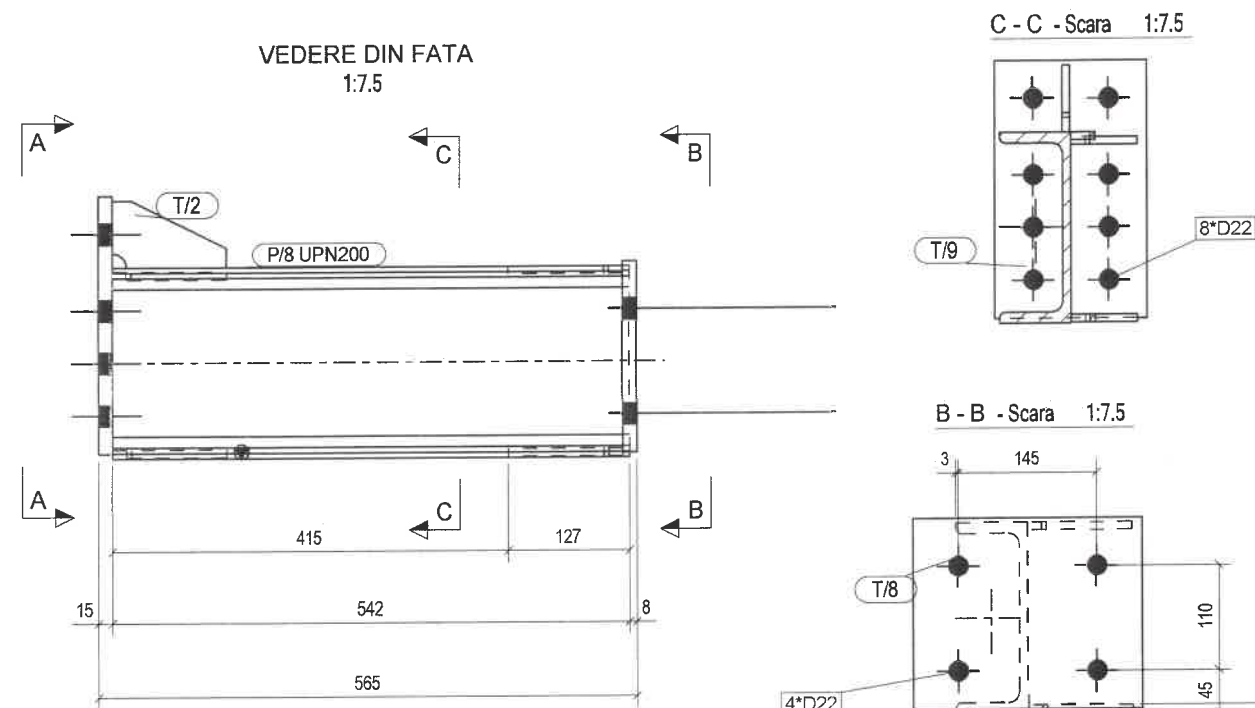
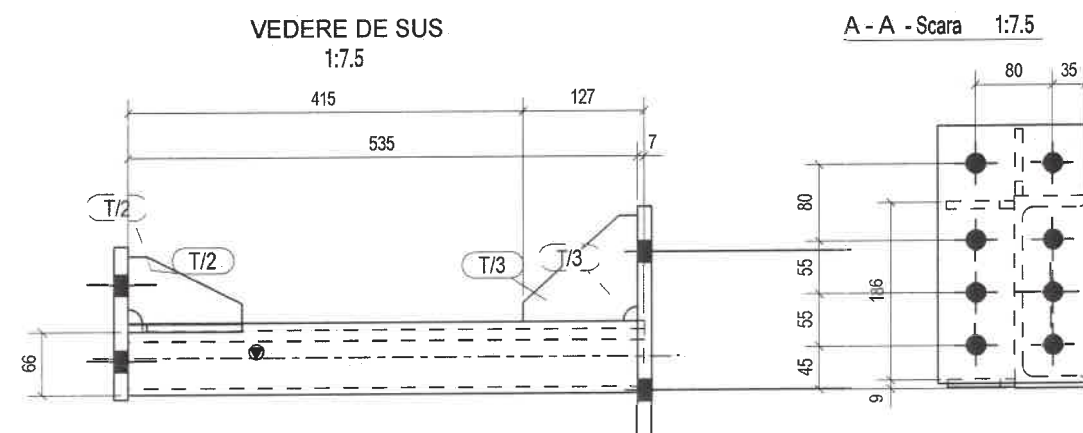

LISTA MATERIALE PENTRU 1 BUC. ANSAMBLUL POZ. VS/3				26.6	kg	2	BUCATI DE EXECUTA	
Pozitia	Denumire	Profil	Material	Bucati	Lungime [mm]	Suprafata [m2]	Masa [kg]	
P/8	VANG SCARA	UPN200	S235JR	1	542	0.36	13.7	
T/8	PLACA DE CAPAT	PL15*240	S235JR	1	200	0.11	5.7	
T/9	PLACA DE CAPAT	PL15*160	S235JR	1	270	0.10	5.1	
T/3	RIGIDIZARE	PL8*110	S235JR	2	120	0.02	0.5	
T/2	RIGIDIZARE	PL8*70	S235JR	3	120	0.01	0.4	
Total						0.65	26.6	

BENEFICIAR:	ADMINISTRATIA COMERCIALA SECTOR 6			PROIECT:	PIATA VALEA IALOMITEI		
PROIECTANT REZISTENTA:	SC LGC CONCEPT DESIGN SRL						
DENUMIRE PLANSĂ:	PLAN UZINARE ANSAMBLUL: VS/3						
PROIECTANT: ing. Stefan Neacsu	SCARA: 1:7.5				Nr. Crt. VS/3		

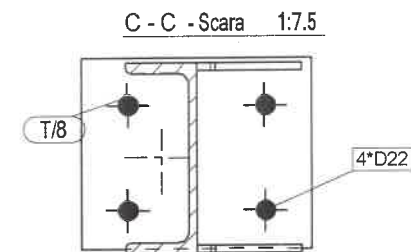
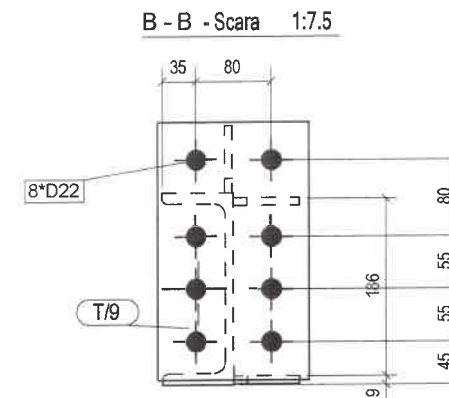
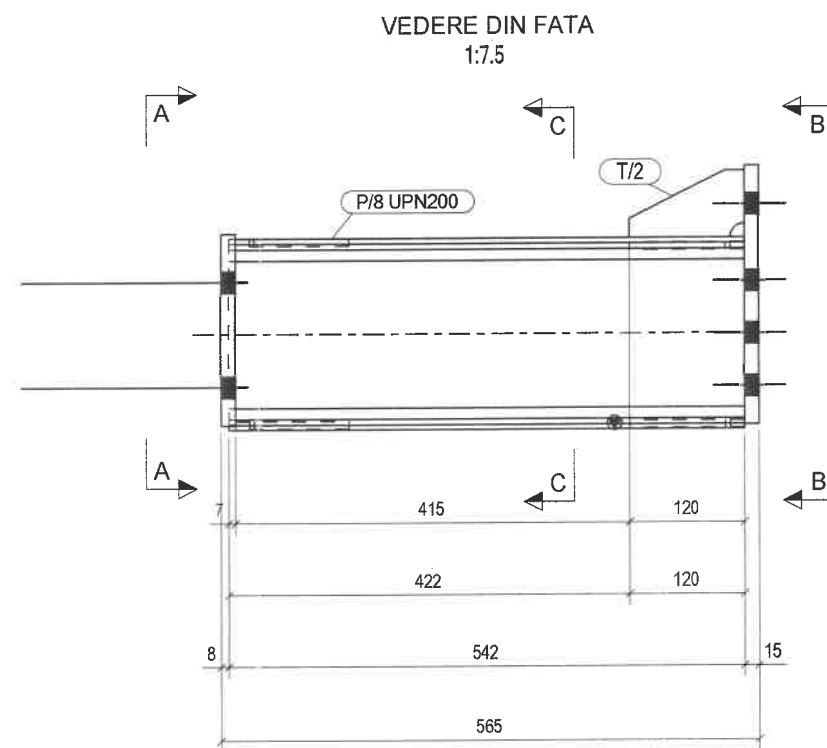
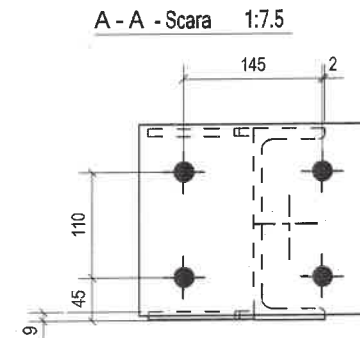
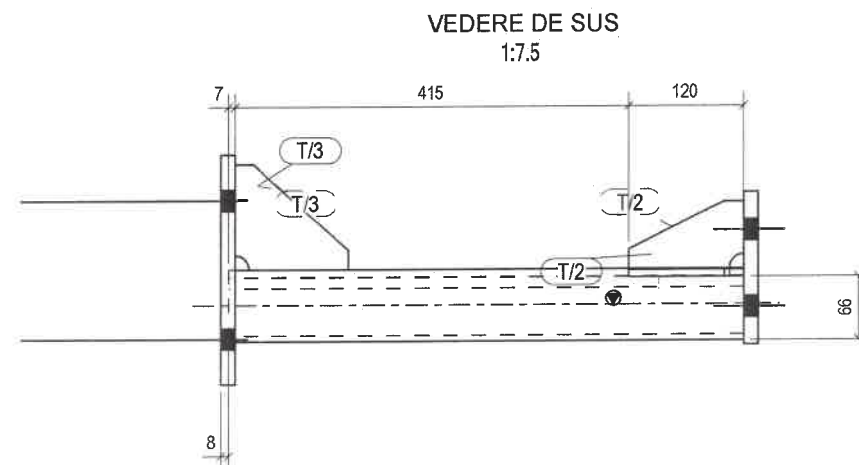

LISTA MATERIALE PENTRU 1 BUC. ANSAMBLUL POZ. VS/4			26.6	kg	2	BUCATI DE EXECUTA	
Pozitia	Denumire	Profil	Material	Bucati	Lungime [mm]	Suprafata [m2]	Masa [kg]
P/8	VANG SCARA	UPN200	S235JR	1	542	0.36	13.7
T/8	PLACA DE CAPAT	PL15*240	S235JR	1	200	0.11	5.7
T/9	PLACA DE CAPAT	PL15*160	S235JR	1	270	0.10	5.1
T/3	RIGIDIZARE	PL8*110	S235JR	2	120	0.02	0.5
T/2	RIGIDIZARE	PL8*70	S235JR	3	120	0.01	0.4
Total						0.65	26.6

BENEFICIAR:	ADMINISTRATIA COMERCIALA SECTOR 6	PROIECT:	PIATA VALEA IALOMITEI
PROIECTANT REZISTENTA:	SC LGC CONCEPT DESIGN SRL		
DENUMIRE PLANSĂ:	PLAN UZINARE ANSAMBLUL: VS/4		
PROIECTANT:	ing. Stefan Neacsu	SCARA: 1:7.5	Nr. Crt. VS/4

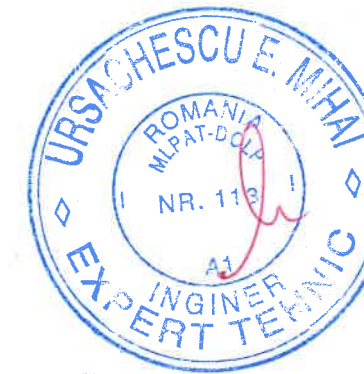
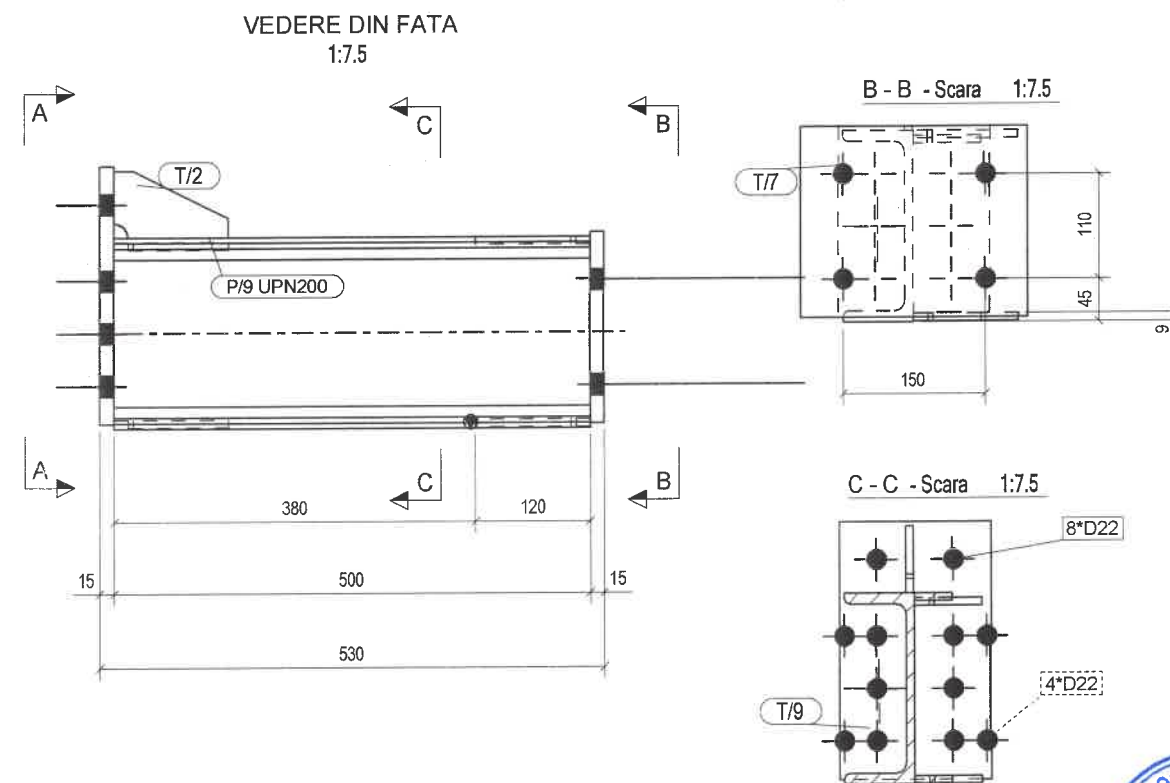
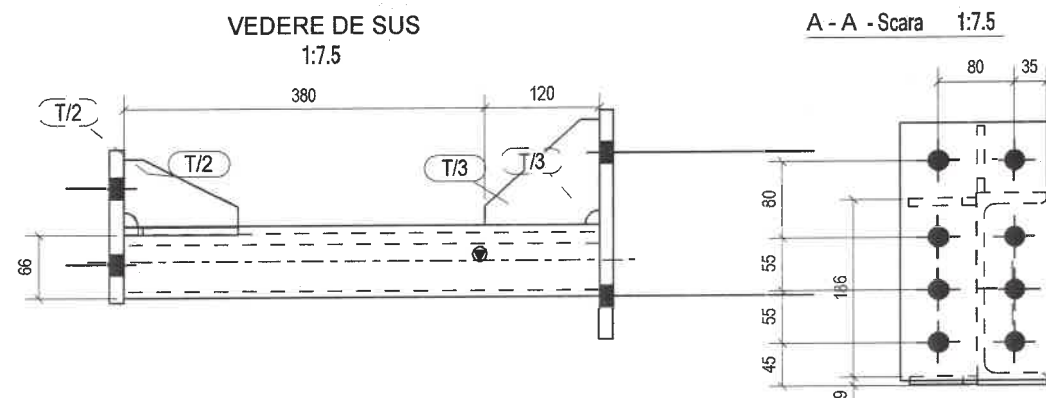

LISTA MATERIALE PENTRU 1 BUC. ANSAMBLUL POZ.				VS/5	25.5	kg	1	BUCATI DE EXECUTA
Pozitia	Denumire	Profil	Material	Bucati	Lungime [mm]	Suprafata [m2]	Masa [kg]	
P/9	VANG SCARA	UPN200	S235JR	1	500	0.33	12.6	
T/7	PLACA DE CAPAT	PL15*240	S235JR	1	200	0.11	5.7	
T/9	PLACA DE CAPAT	PL15*160	S235JR	1	270	0.10	5.1	
T/3	RIGIDIZARE	PL8*110	S235JR	2	120	0.02	0.5	
T/2	RIGIDIZARE	PL8*70	S235JR	3	120	0.01	0.4	
Total						0.62	25.5	

BENEFICIAR:	ADMINISTRATIA COMERCIALA SECTOR 6	PROIECT:	PIATA VALEA IALOMITEI
PROIECTANT REZISTENTA:	SC LGC CONCEPT DESIGN SRL		
DENUMIRE PLANSĂ:	PLAN UZINARE ANSAMBLUL:	VS/5	
PROIECTANT:	ing. Stefan Neacsu	SCARA: 1:7.5	Nr. Crt: VS/5

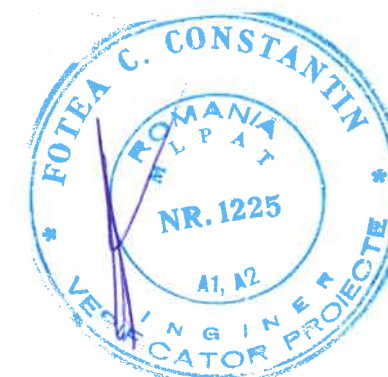
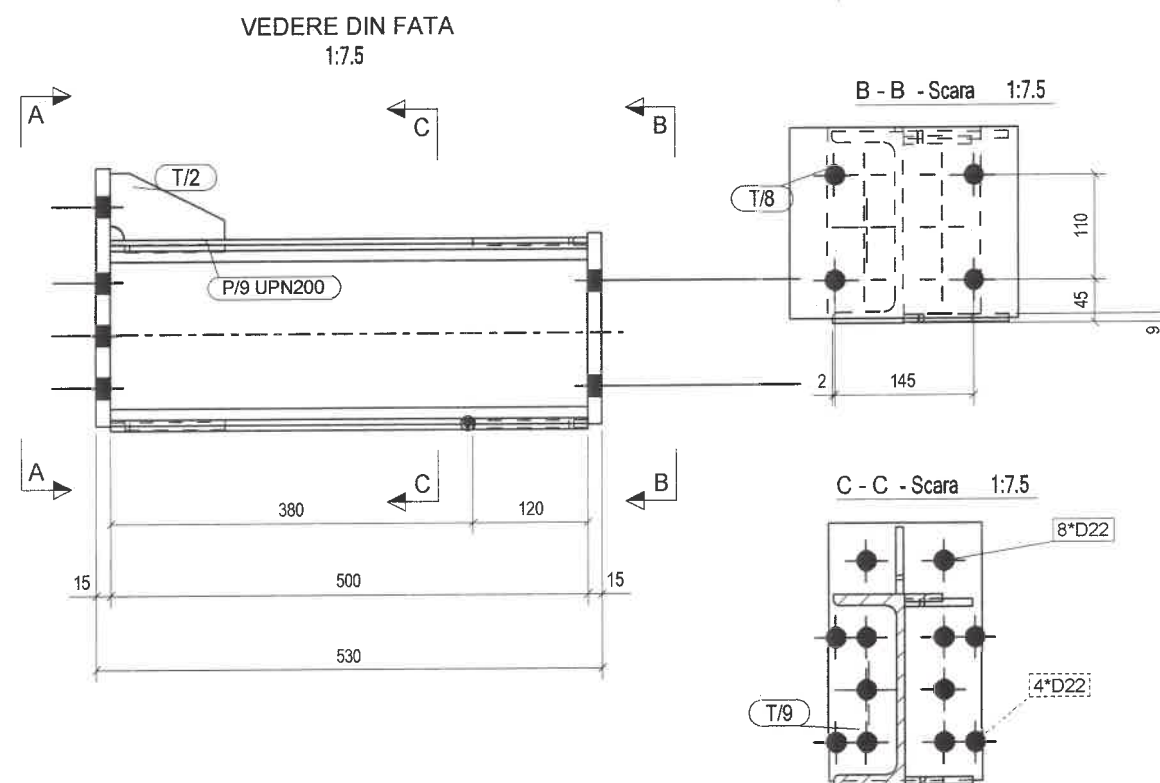
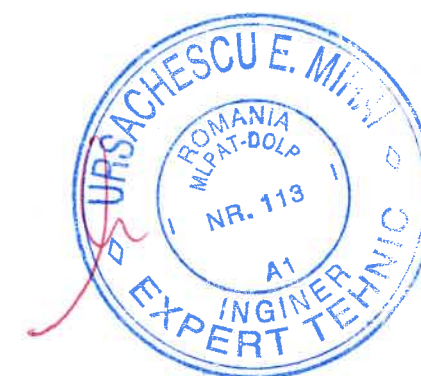
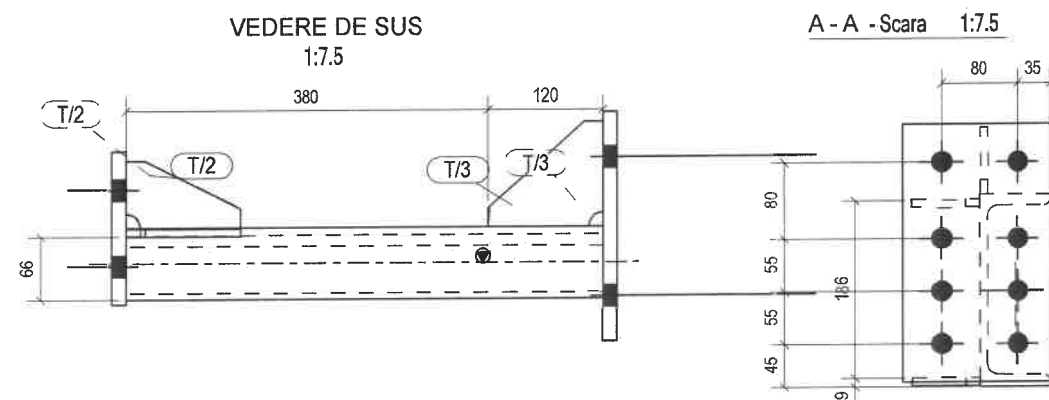

LISTA MATERIALE PENTRU 1 BUC. ANSAMBLUL POZ. VS/6			25.5	kg	1	BUCATI DE EXECUTA	
Pozitia	Denumire	Profil	Material	Bucati	Lungime [mm]	Suprafata [m2]	Masa [kg]
P/9	VANG SCARA	UPN200	S235JR	1	500	0.33	12.6
T/8	PLACA DE CAPAT	PL15*240	S235JR	1	200	0.11	5.7
T/9	PLACA DE CAPAT	PL15*160	S235JR	1	270	0.10	5.1
T/3	RIGIDIZARE	PL8*110	S235JR	2	120	0.02	0.5
T/2	RIGIDIZARE	PL8*70	S235JR	3	120	0.01	0.4
Total						0.62	25.5

BENEFICIAR:			PROIECT:	
ADMINISTRATIA COMERCIALA SECTOR 6			PIATA VALEA IALOMITEI	
PROIECTANT REZISTENTA: SC LGC CONCEPT DESIGN SRL				
DENUMIRE PLANSĂ:			PLAN UZINARE ANSAMBLUL: VS/6	
PROIECTANT: ing. Stefan Neacsu			SCARA: 1:7.5	
			Nr. Crt. VS/6	

[illegible]

Technical drawing of a mechanical part, showing a cross-section with dimensions 75 and 8.

Technical drawing of a rectangular plate. Dimensions are given in millimeters: 80 (total width), 35 (width of the right section), 55 (total height), 45 (height of the left section), 116 (width of the central section), and 9 (height of the bottom section). A label 'T/9' is shown in a circle, pointing to the central section. A label '8*D22' is shown in a rectangle, pointing to the central section.

Technical drawing of a mechanical assembly. The drawing shows a side view of a component with a vertical section on the left and a horizontal section extending to the right. Dimensions are indicated: a vertical dimension of 66 on the left, a horizontal dimension of 120 from the vertical section to the start of a series of rectangular slots, and a total horizontal dimension of 454. A label $T/2$ is enclosed in an oval below the horizontal section.

Technical drawing of a vertical component, likely a pipe or tube, with a flange at the top. The drawing shows a cross-section of the flange and a dimension of 75 indicated at the bottom right.

Technical drawing of a 1000 mm long rod. The rod has a total length of 1000 mm. It features three T-shaped sections. The first two sections are labeled T/10 and the third is labeled T/2. The dimensions 75 and 66 are indicated at the top left of the drawing.

75

BENEFICIAR:		PROIECT:	
ADMINISTRATIA COMERCIALA SECTOR 6		PIATA VALEA IALOMITEI	
PROIECTANT REZISTENTA: SC LGC CONCEPT DESIGN SRL			
DENUMIRE PLANSĂ:		PLAN UZINARE ANSAMBLUL: VS/7	
PROIECTANT: ing. Stefan Neacsu		SCARA: 1:15 1:20	
		Nr. Crt VS/7	



VEDERE DIN FATA
1:15

E - E - Scara 1:20

F - F - Scara 1:20

K - K - Scara 1:20

B - B - Scara 1:20

D - D - Scara 1:20

G - G - Scara 1:20

C - C - Scara 1:20

A - A - Scara 1:20

I - I - Scara 1:20

J - J - Scara 1:20

H - H - Scara 1:20

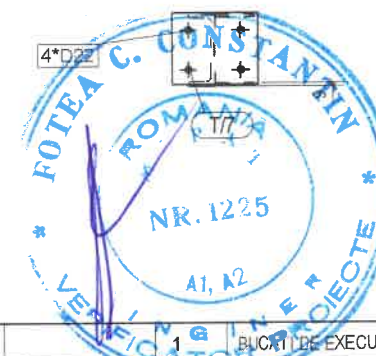

LISTA MATERIALE PENTRU 1 BUC. ANSAMBLUL POZ. VS/8				137.8	kg	1 BUC. DE EXECUTA		
Pozitia	Denumire	Profil	Material	Bucati	Lungime [mm]	Suprafata [m2]	Masa [kg]	
P/4	VANG SCARA	UPN200	S235JR	1	2922	1.93	73.8	
P/16	VANG SCARA	UPN200	S235JR	1	574	0.38	14.5	
P/13	VANG SCARA	UPN200	S235JR	1	455	0.30	11.5	
T/7	PLACA DE CAPAT	PL15*240	S235JR	1	200	0.11	5.7	
T/9	PLACA DE CAPAT	PL15*160	S235JR	1	270	0.10	5.1	
T/1	RIGIDIZARE	PL8*158	S235JR	8	271	0.05	1.5	
T/10	TRAPTA	PL6*75	S235JR	8	300	0.05	1.1	
T/11	TRAPTA	PL6*75	S235JR	8	168	0.03	0.6	
T/3	RIGIDIZARE	PL8*110	S235JR	2	120	0.02	0.5	
T/2	RIGIDIZARE	PL8*70	S235JR	3	120	0.01	0.4	
Total						3.94	137.8	

BENEFICIAR:

ADMINISTRATIA COMERCIALA SECTOR 6

PROIECT:

PIATA VALEA IALOMITEI

PROIECTANT REZISTENTA: SC LGC CONCEPT DESIGN SRL

DENUMIRE PLANSA:

PLAN UZINARE ANSAMBLUL: VS/8

PROIECTANT: ing. Stefan Neacsu

SCARA: 1:15 1:20

Nr. Crt
VS/8

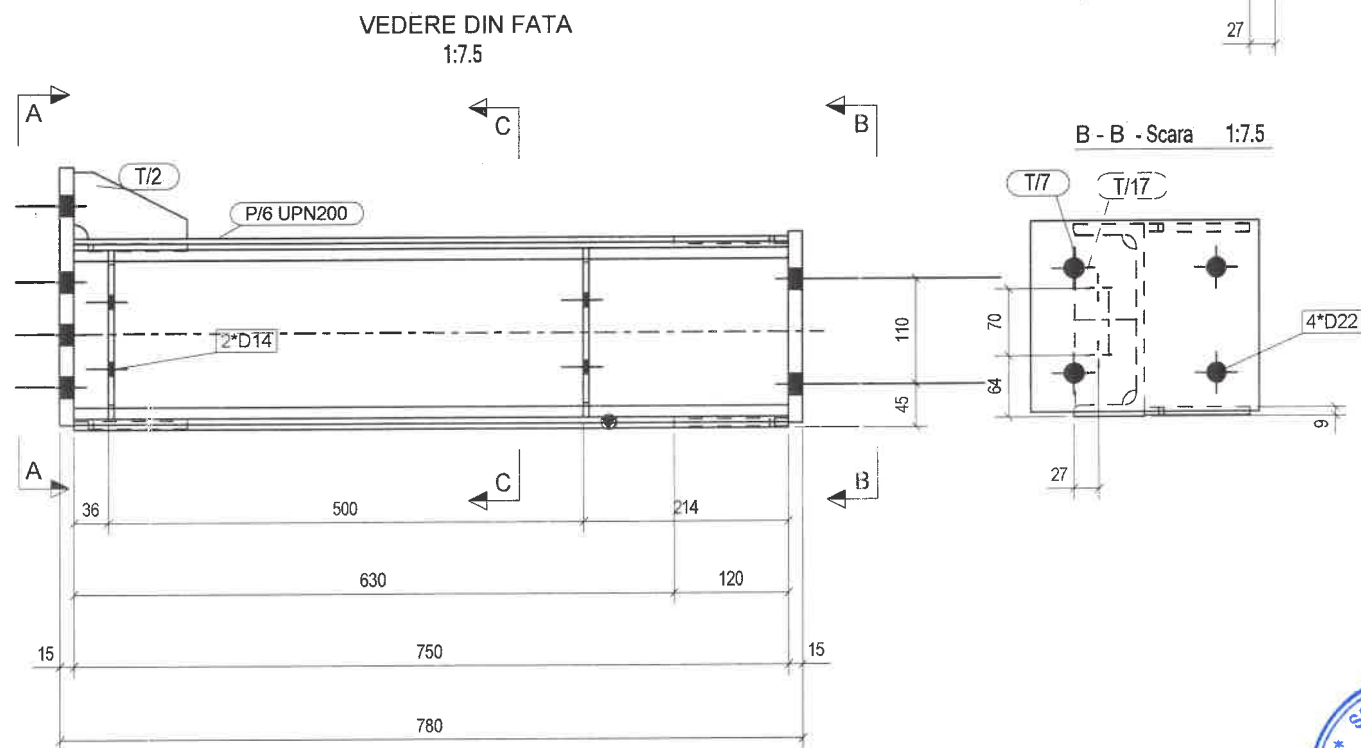
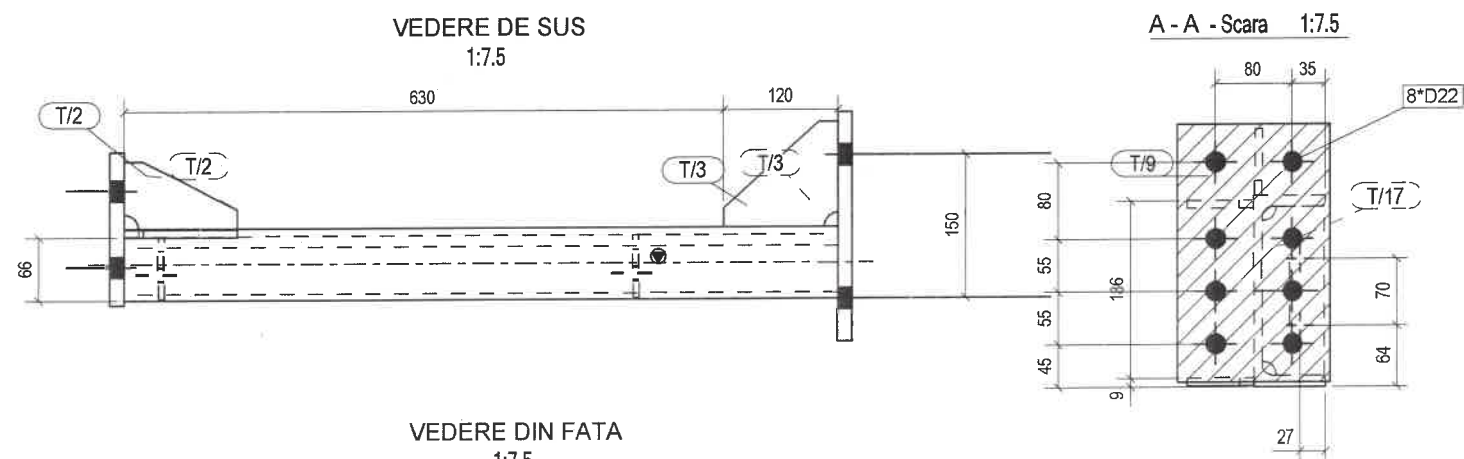

C - C - Scara 1:7.5

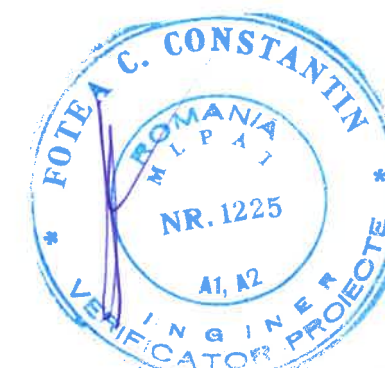
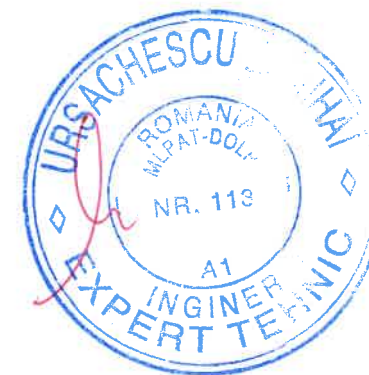
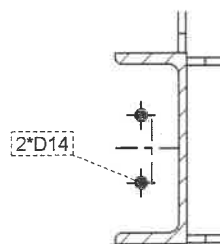

LISTA MATERIALE PENTRU 1 BUC. ANSAMBLUL POZ. VS/9				32.9	kg	1	BUCATI DE EXECUTA	
Pozitia	Denumire	Profil	Material	Bucati	Lungime [mm]	Suprafata [m2]	Masa [kg]	
P/6	VANG SCARA	UPN200	S235JR	1	750	0.50	19.0	
T/7	PLACA DE CAPAT	PL15*240	S235JR	1	200	0.11	5.7	
T/9	PLACA DE CAPAT	PL15*160	S235JR	1	270	0.10	5.1	
T/3	RIGIDIZARE	PL8*110	S235JR	2	120	0.02	0.5	
T/17	RIGIDIZARE	PL6*65	S235JR	2	177	0.03	0.5	
T/2	RIGIDIZARE	PL8*70	S235JR	3	120	0.01	0.4	
Total						0.84	32.9	

BENEFICIAR:			PROIECT:		
ADMINISTRATIA COMERCIALA SECTOR 6			PIATA VALEA IALOMITEI		
PROIECTANT REZISTENTA: SC LGC CONCEPT DESIGN SRL					
DENUMIRE PLANSĂ: PLAN UZINARE ANSAMBLUL: VS/9					
PROIECTANT: ing. Stefan Neacsu			SCARA: 1:7.5		
			Nr. Crt: VS/9		

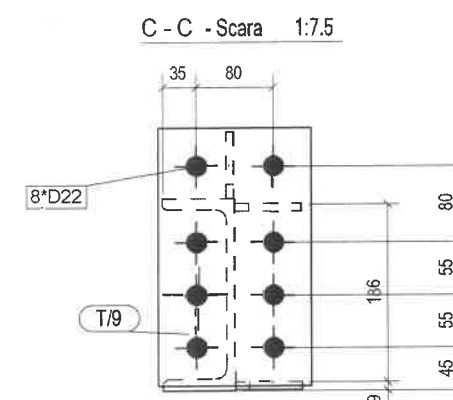
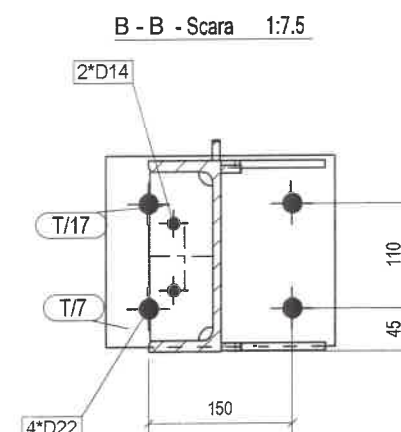
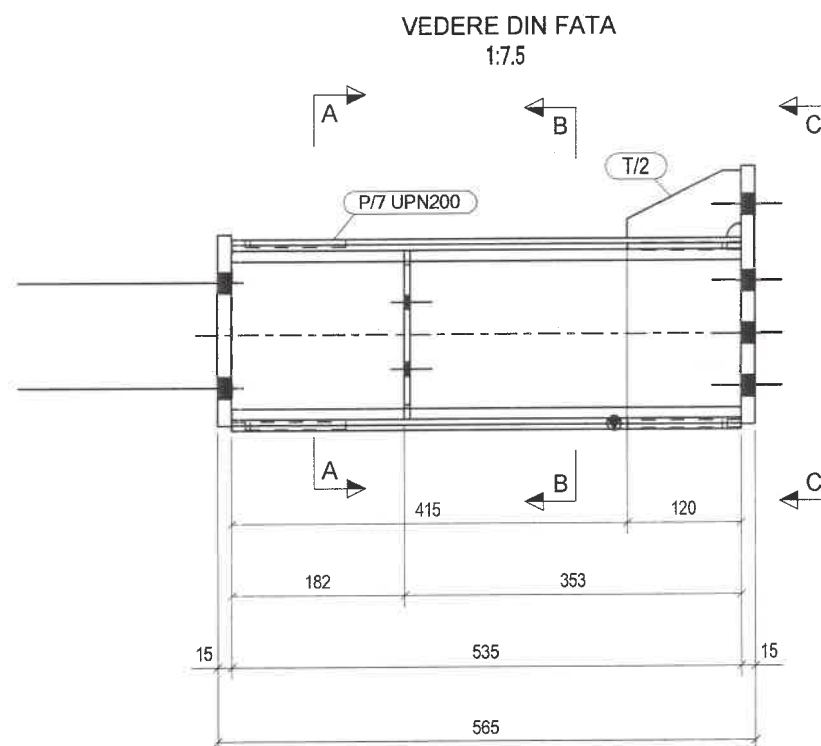
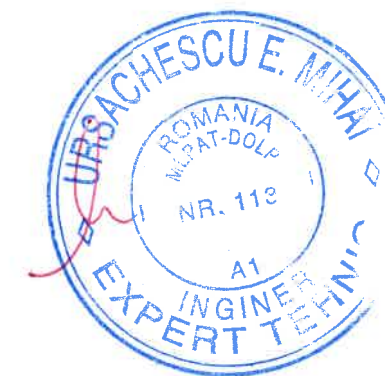
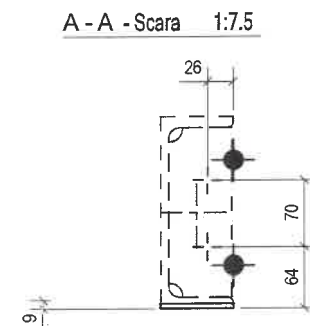
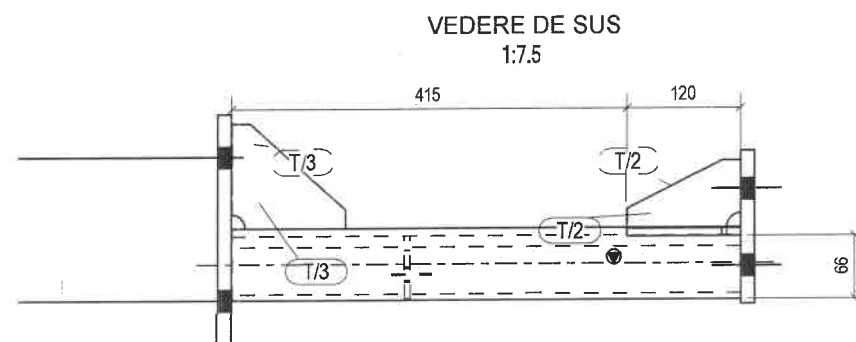

LISTA MATERIALE PENTRU 1 BUC. ANSAMBLUL POZ. VS/10				26.9	kg	1 BUCATI DE EXECUTA		
Pozitia	Denumire	Profil	Material	Bucati	Lungime [mm]	Suprafata [m2]	Masa [kg]	
P/7	VANG SCARA	UPN200	S235JR	1	535	0.35	13.5	
T/7	PLACA DE CAPAT	PL15*240	S235JR	1	200	0.11	5.7	
T/9	PLACA DE CAPAT	PL15*160	S235JR	1	270	0.10	5.1	
T/3	RIGIDIZARE	PL8*110	S235JR	2	120	0.02	0.5	
T/17	RIGIDIZARE	PL6*65	S235JR	1	177	0.03	0.5	
T/2	RIGIDIZARE	PL8*70	S235JR	3	120	0.01	0.4	
Total						0.67	26.9	

BENEFICIAR:			PROIECT:		
ADMINISTRATIA COMERCIALA SECTOR 6			PIATA VALEA IALOMITEI		
PROIECTANT REZISTENTA: SC LGC CONCEPT DESIGN SRL					
DENUMIRE PLANSA: PLAN UZINARE ANSAMBLUL: VS/10					
PROIECTANT: ing. Stefan Neacsu			SCARA: 1:7.5		Nr. Crt. VS/10

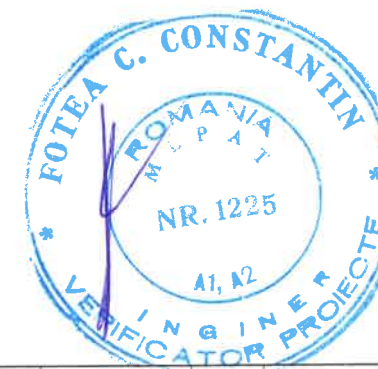
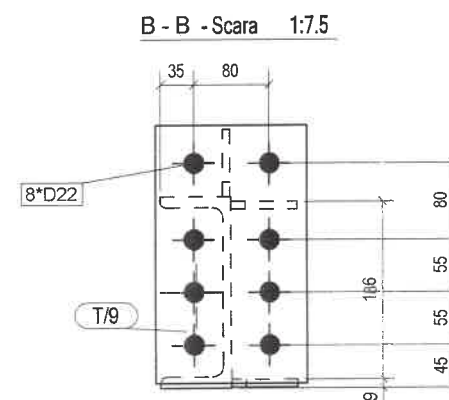
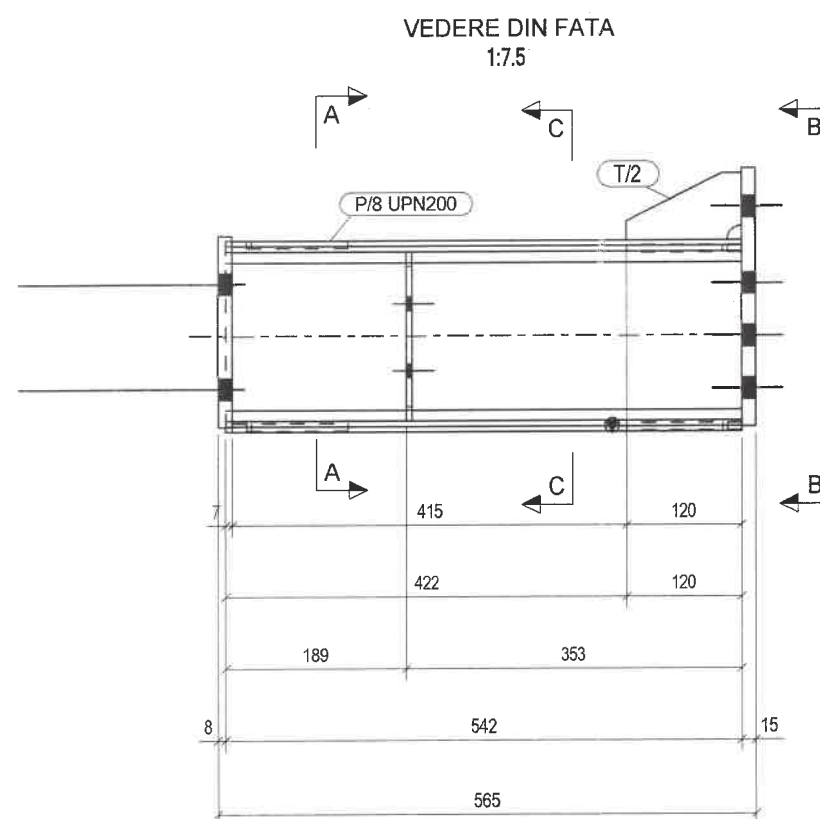
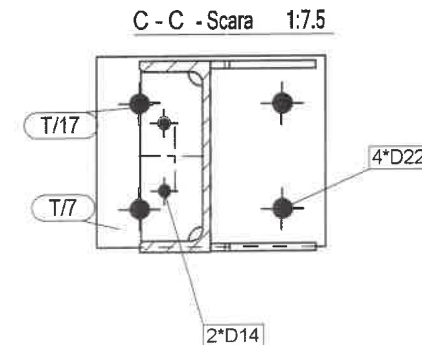
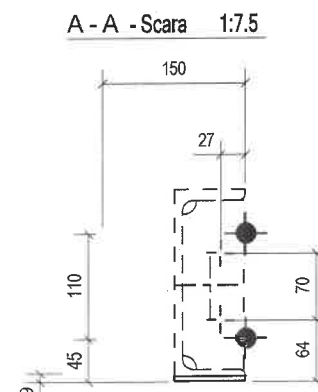
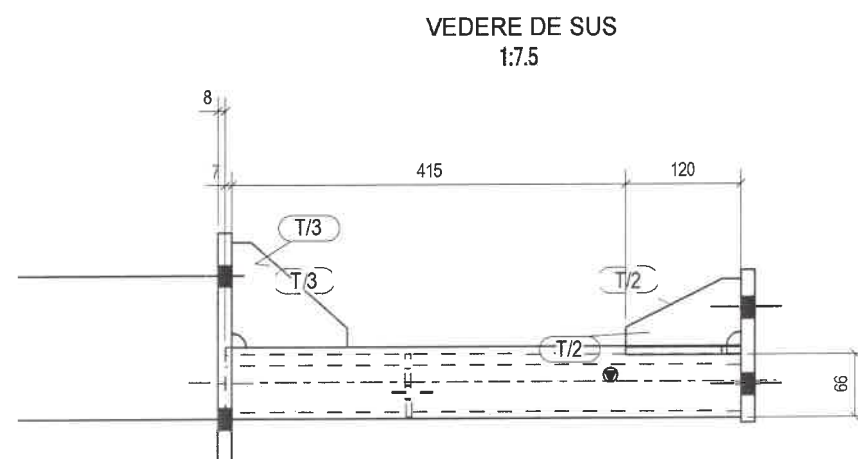

LISTA MATERIALE PENTRU 1 BUC. ANSAMBLUL POZ. VS/11			27.1	kg	1	BUCATI DE EXECUTA	
Pozitia	Denumire	Profil	Material	Bucati	Lungime [mm]	Suprafata [m2]	Masa [kg]
P/8	VANG SCARA	UPN200	S235JR	1	542	0.36	13.7
T/7	PLACA DE CAPAT	PL15*240	S235JR	1	200	0.11	5.7
T/9	PLACA DE CAPAT	PL15*160	S235JR	1	270	0.10	5.1
T/3	RIGIDIZARE	PL8*110	S235JR	2	120	0.02	0.5
T/17	RIGIDIZARE	PL6*65	S235JR	1	177	0.03	0.5
T/2	RIGIDIZARE	PL8*70	S235JR	3	120	0.01	0.4
Total						0.67	27.1

BENEFICIAR:		PROIECT:	
ADMINISTRATIA COMERCIALA SECTOR 6		PIATA VALEA IALOMITEI	
PROIECTANT REZISTENTA: SC LGC CONCEPT DESIGN SRL			
DENUMIRE PLANSA:		PLAN UZINARE ANSAMBLUL: VS/11	
PROIECTANT: ing. Stefan Neacsu		SCARA: 1:7.5	
		Nr. Crt. VS/11	

Technical drawing of a roof truss system. The drawing shows a cross-section of the truss with various dimensions and angles. Key dimensions include a total width of 2295 and a total height of 105. The truss is composed of several members, including top chords (P/1 UPN200, P/10), bottom chords (T/1, T/10, T/11, T/13, T/16), and diagonal bracing (T/1, T/10, T/11, T/13, T/16). The drawing also shows the connection details between the truss members and the supporting structure, including the use of 1"D18 bolts. The drawing is oriented with a 30° angle to the horizontal.

Technical drawing of a vertical assembly. A callout bubble labeled "T/12" points to a component. Below it, a dimension line indicates a height of 8. At the bottom, a dimension line indicates a total height of 75.

Technical drawing of a vertical rod assembly. Dimensions shown: 75 (total height), 26 (top section), 8 (middle section), and 70 (bottom section). Labels include T/16, T/11, and 2°D14.

Technical drawing of a vertical pipe assembly. Dimensions shown: 75 (total height), 26 (height from top to first fitting), 6 (height of first fitting), 70 (height from bottom to second fitting), and 2 (height of second fitting). Labels: T/16 (pointing to the first fitting) and 2" D1 (pointing to the second fitting).

BENEFICIAR:		PROJECT:	
ADMINISTRATIA COMERCIALA SECTOR 6		PIATA VALEA IALOMITEI	
PROJECTANT REZISTENTA: SC LGC CONCEPT DESIGN SRL			
DENUMIRE PLANS:		PLAN UZINARE ANSAMBLUL: VS/12	
PROJECTANT: ing. Stefan Neacsu		SCARA: 1:15 1:20	
		Nr. Crt. VS/12	

VEDERE DIN FATA
1:10

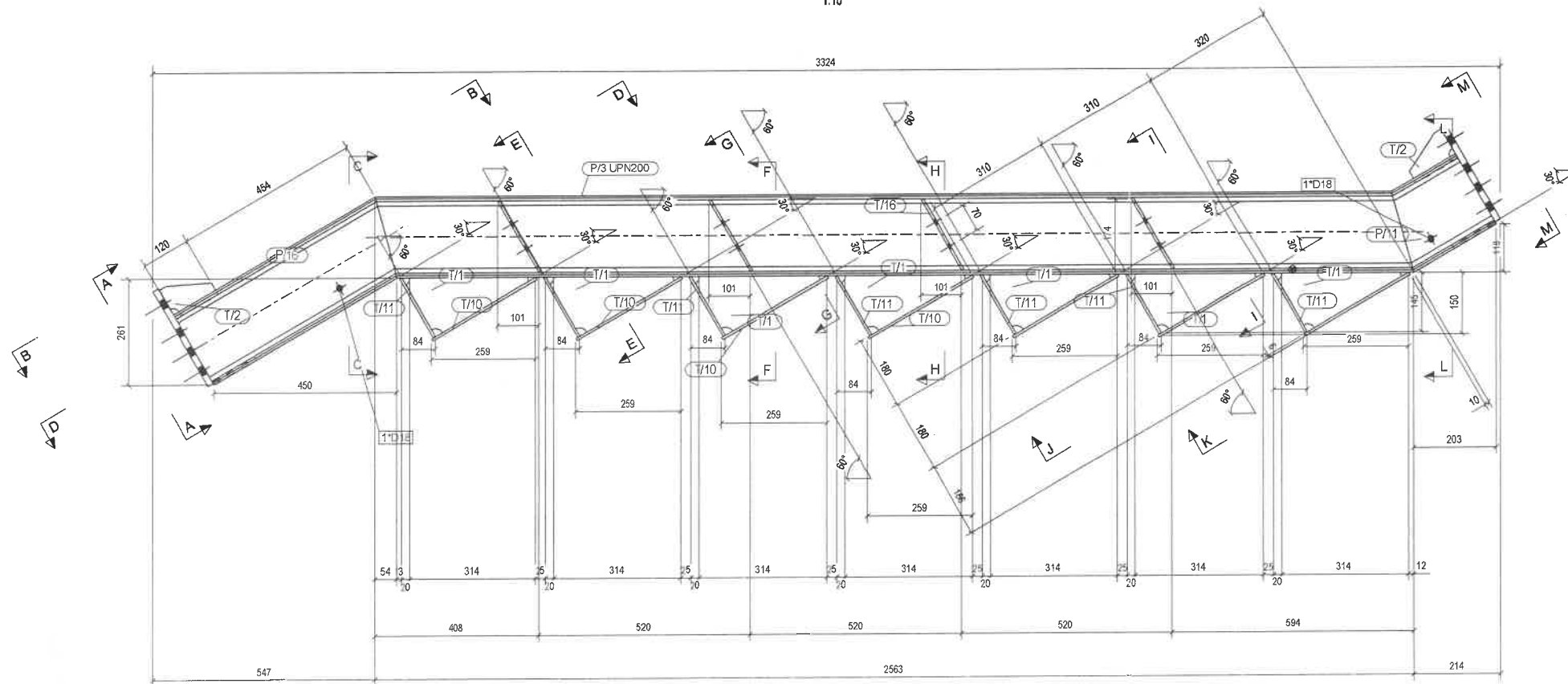

E - E - Scara 1:10

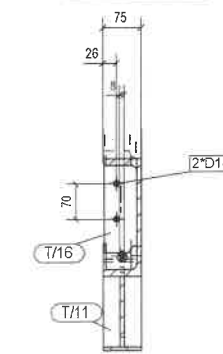

H - H - Scara 1:10



M - M - Scara 1:10

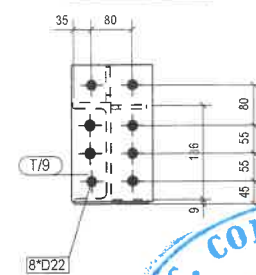

B - B - Scara 1:10



C - C - Scara 1:10

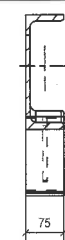

D - D - Scara 1:10

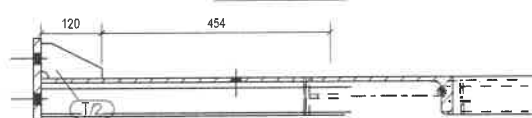

F - F - Scara 1:10



G - G - Scara 1:10

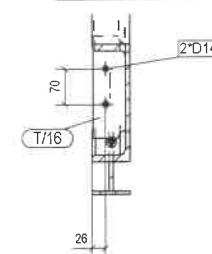

A - A - Scara 1:10

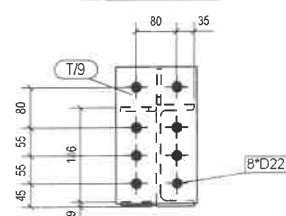

I - I - Scara 1:10

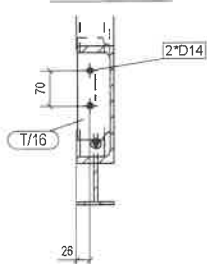

J - J - Scara 1:10

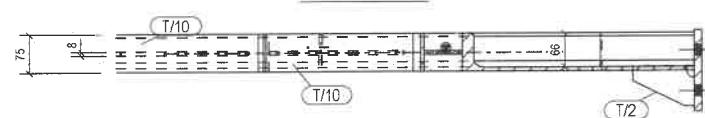

K - K - Scara 1:10

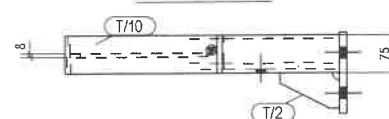

L - L - Scara 1:10

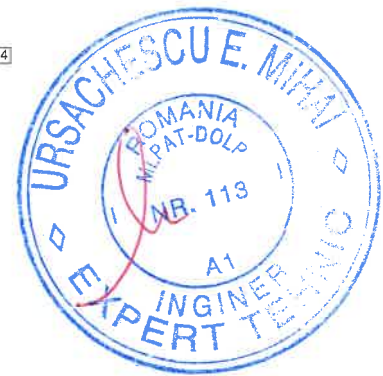

LISTA MATERIALE PENTRU 1 BUC. ANSAMBLUL POZ.			VS/13	121.9	kg	1	BUCATI DE EXECUT.		
Pozitia	Denumire	Profil	Material	Bucati	Lungime (mm)	Suprafata (m2)	Masa (kg)		
P/3	VANG SCARA	UPN200	S235JR	1	2563	1.69	64.8		
P/16	VANG SCARA	UPN200	S235JR	1	574	0.38	14.5		
P/11	VANG SCARA	UPN200	S235JR	1	235	0.16	5.9		
T/9	PLACA DE CAPAT	PL15*160	S235JR	2	270	0.10	5.1		
T/1	RIGIDIZARE	PL8*158	S235JR	7	271	0.05	1.5		
T/10	TRAPTA	PL8*75	S235JR	7	300	0.05	1.1		
T/11	TRAPTA	PL8*75	S235JR	7	168	0.03	0.6		
T/16	RIGIDIZARE	PL8*65	S235JR	4	201	0.03	0.6		
T/2	RIGIDIZARE	PL8*70	S235JR	6	120	0.01	0.4		
Total							3.54	121.9	

BENEFICIAR:
ADMINISTRATIA COMERCIALA SECTOR 6

PROIECTANT REZISTENTA: SC LGC CONCEPT DESIGN SR

DENUMIRE PLANSĂ:

PROIECTANT: ing. Stefan Neacsu

PROIECT:
PIATA VALEA IALOMITEI

PLAN UZINARE ANSAMBLUL: VS/13

SCARA: 1:10

Nr. Crt. VS/13

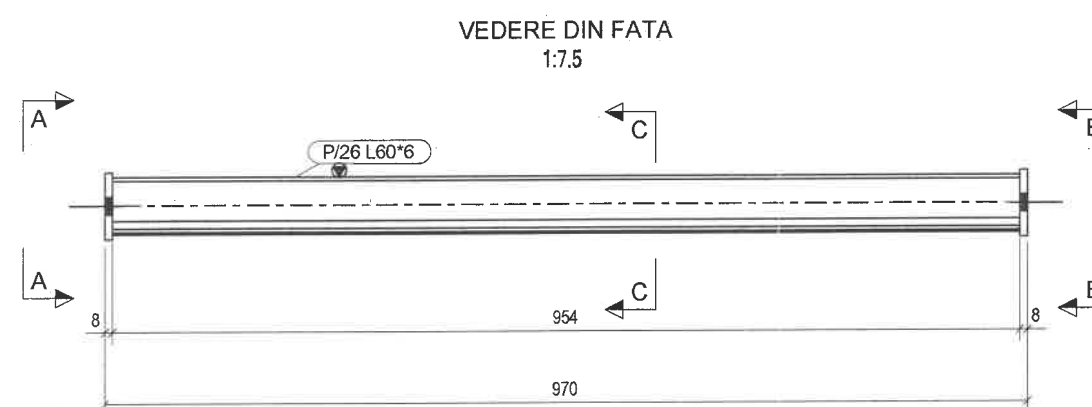

A - A - Scara 1:7.5

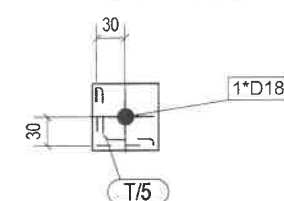

B - B - Scara 1:7.5

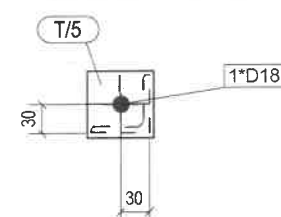

C - C - Scara 1:7.5

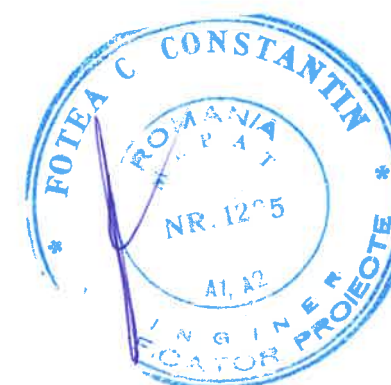

LISTA MATERIALE PENTRU 1 BUC. ANSAMBLUL POZ.				CF/1	5.8	kg	3	BUCATI DE EXECUTAT
Pozitia	Denumire	Profil	Material	Bucati	Lungime [mm]	Suprafata [m2]	Masa [kg]	
P/26	CF	L60*6	S235JR	1	954	0.22	5.2	
T/5	PLACA DE CAPAT	PL8*70	S235JR	2	70	0.01	0.3	
Total						0.25	5.8	

BENEFICIAR:				PROIECT:			
ADMINISTRATIA COMERCIALA SECTOR 6				PIATA VALEA IALOMITEI			
PROIECTANT REZISTENTA: SC LGC CONCEPT DESIGN SRL							
DENUMIRE PLANSĂ:				PLAN UZINARE ANSAMBLUL: CF/1			
PROIECTANT: ing. Stefan Neacsu				SCARA: 1:7.5		Nr. Crt: CF/1	

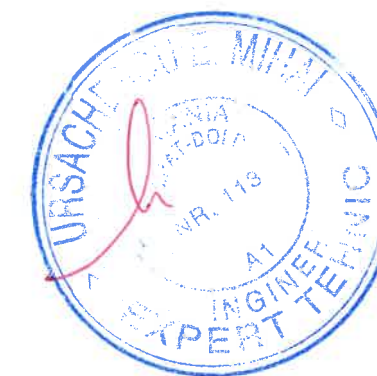
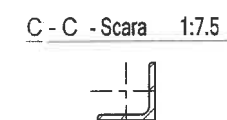
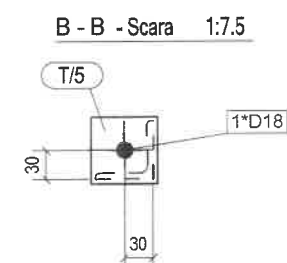
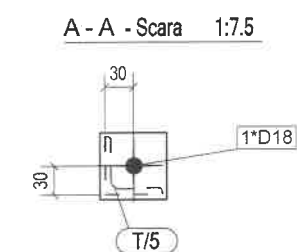
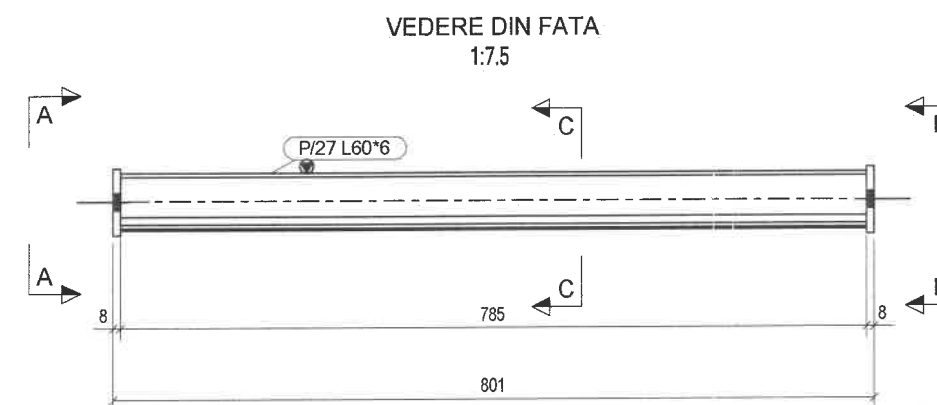

LISTA MATERIALE PENTRU 1 BUC. ANSAMBLUL POZ. CF/2			4.9	kg	4			BUCATI DE EXECUTAT
Pozitia	Denumire	Profil	Material	Bucati	Lungime [mm]	Suprafata [m2]	Masa [kg]	
P/27	CF	L60*6	S235JR	1	785	0.18	4.3	
T/5	PLACA DE CAPAT	PL8*70	S235JR	2	70	0.01	0.3	
Total						0.21	4.9	

BENEFICIAR:			PROIECT:	
ADMINISTRATIA COMERCIALA SECTOR 6			PIATA VALEA IALOMITEI	
PROIECTANT REZISTENTA: SC LGC CONCEPT DESIGN SRL				
DENUMIRE PLANSĂ:			PLAN UZINARE ANSAMBLUL: CF/2	
PROIECTANT: ing. Stefan Neacsu			SCARA: 1:7.5	Nr. Crt: CF/2

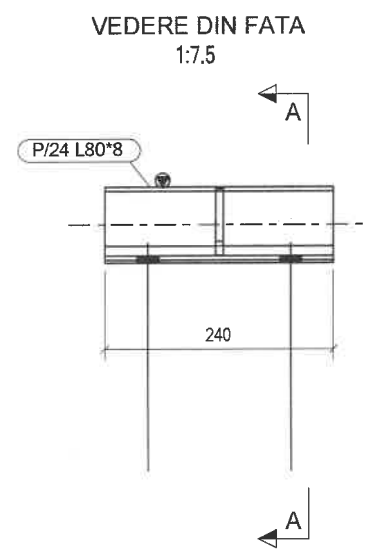
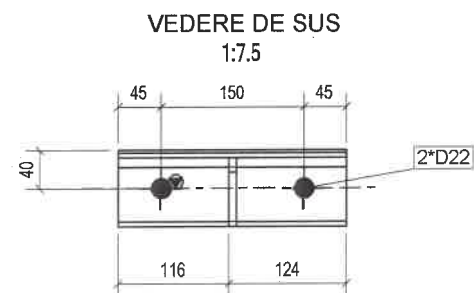

A - A - Scara 1:7.5

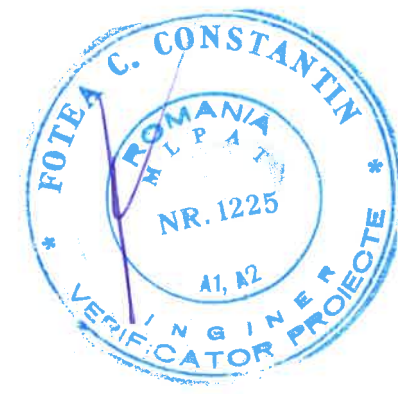

LISTA MATERIALE PENTRU 1 BUC. ANSAMBLUL POZ.			SV/1	2.5	kg	7	BUCATI DE EXECUTA	
Pozitia	Denumire	Profil	Material	Bucati	Lungime [mm]	Suprafata [m2]	Masa [kg]	
P/24	SUPORT VANG	L80*8	S235JR	1	240	0.07	2.3	
T/4	RIGIDIZARE	PL8*70	S235JR	1	72	0.01	0.2	
Total						0.08	2.5	

BENEFICIAR:			PROIECT:		
ADMINISTRATIA COMERCIALA SECTOR 6			PIATA VALEA IALOMITEI		
PROIECTANT REZISTENTA: SC LGC CONCEPT DESIGN SRL					
DENUMIRE PLANSĂ:			PLAN UZINARE ANSAMBLUL: SV/1		
PROIECTANT: ing. Stefan Neacsu			SCARA: 1:7.5		Nr. Crt. SV/1

VEDERE DE SUS
1:7.5

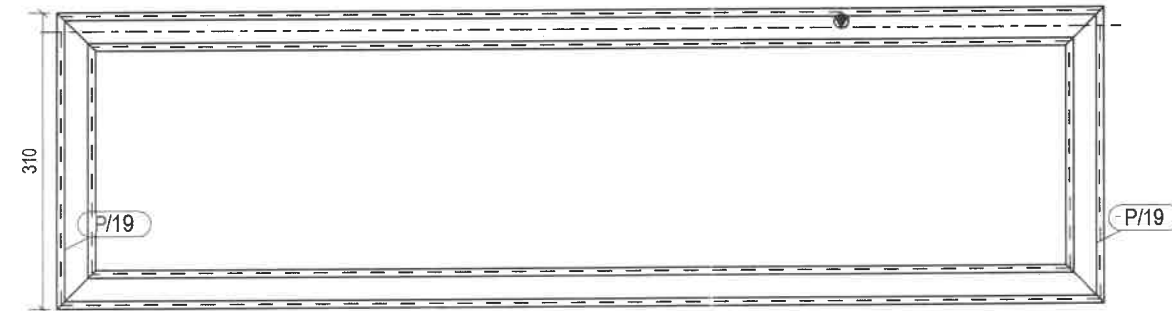

VEDERE DIN FATA
1:7.5

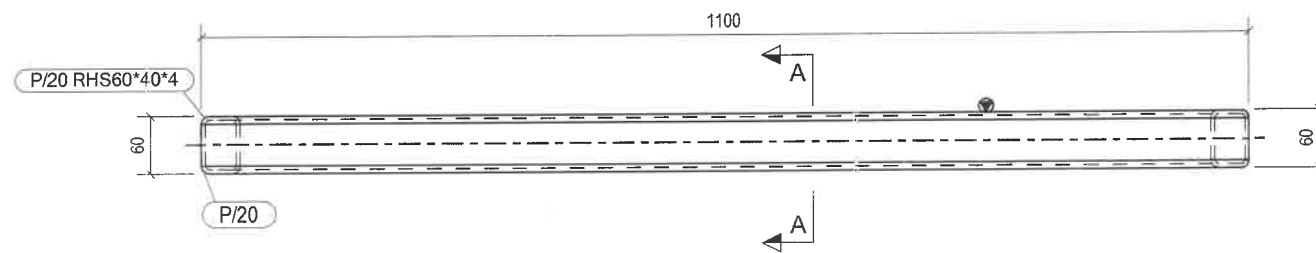

A - A - Scara 1:7.5



LISTA MATERIALE PENTRU 1 BUC. ANSAMBLUL POZ.			TR/1	16.1	kg	24	BUCATI DE EXECUTA	
Pozitia	Denumire	Profil	Material	Bucati	Lungime [mm]	Suprafata [m2]	Masa [kg]	
P/20	TREAPTA	RHS60*40*4	S235JR	2	1100	0.21	6.3	
P/19	TREAPTA	RHS60*40*4	S235JR	2	310	0.06	1.8	
Total						0.54	16.1	

BENEFICIAR:			PROIECT:	
ADMINISTRATIA COMERCIALA SECTOR 6			PIATA VALEA IALOMITEI	
PROIECTANT REZISTENTA: SC LGC CONCEPT DESIGN SRL				
DENUMIRE PLANSĂ:			PLAN UZINARE ANSAMBLUL: TR/1	
PROIECTANT: ing. Stefan Neacsu			SCARA: 1:7.5	Nr. Crt. TR/1

VEDERE DE SUS
1:7.5

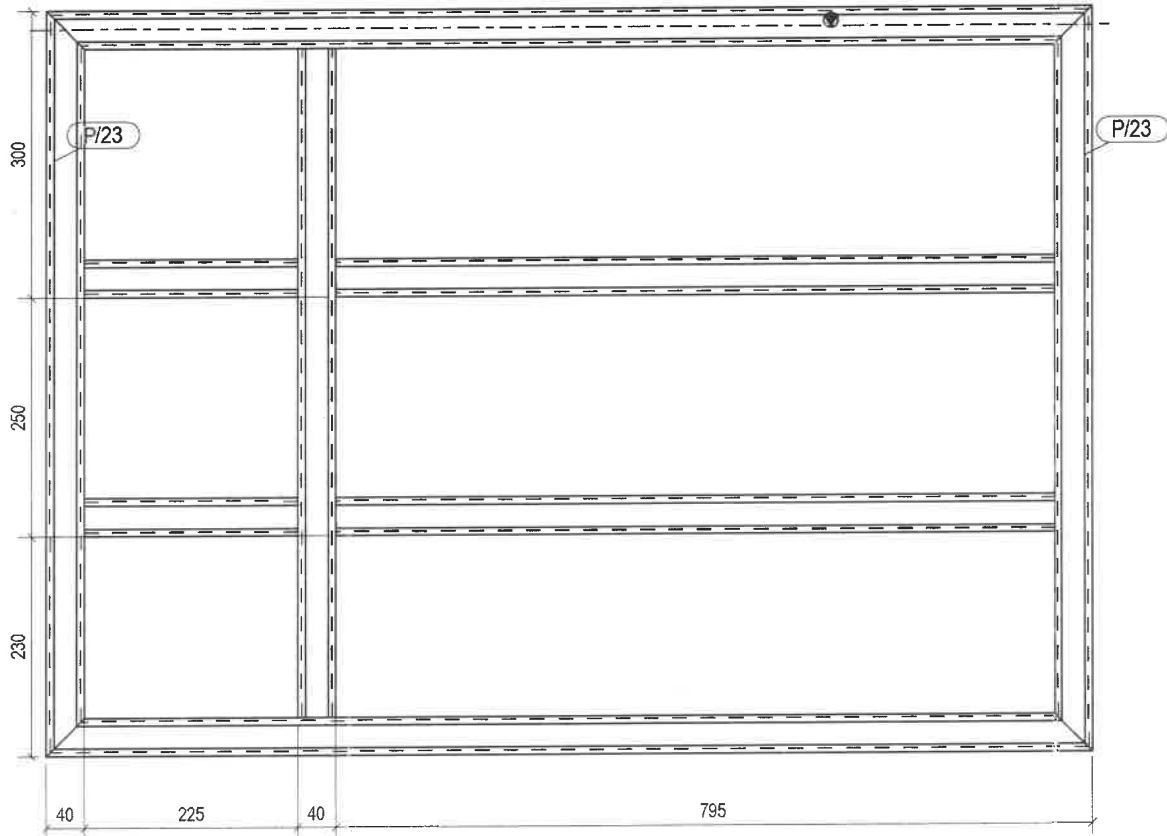

VEDERE DIN FATA
1:7.5

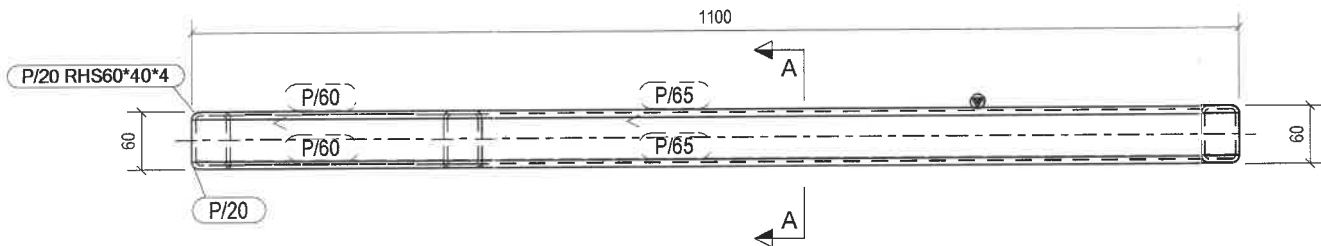

A - A - Scara 1:7.5

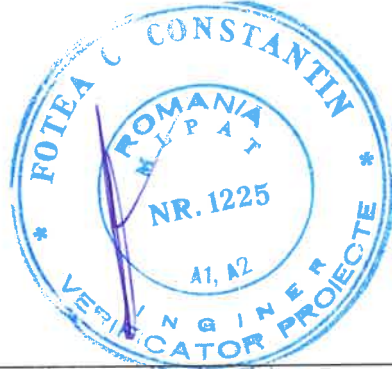
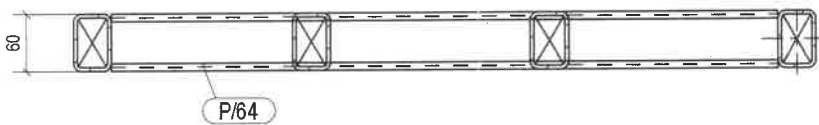

LISTA MATERIALE PENTRU 1 BUC. ANSAMBLUL POZ. TR/2				36.7	kg	1	BUCATI DE EXECUTAT	
Pozitia	Denumire	Profil	Material	Bucati	Lungime [mm]	Suprafata [m2]	Masa [kg]	
P/20	TREAPTA	RHS60*40*4	S235JR	2	1100	0.21	6.3	
P/23	TREAPTA	RHS60*40*4	S235JR	2	780	0.15	4.5	
P/65	TREAPTA	RHS60*40*4	S235JR	2	755	0.14	4.3	
P/64	TREAPTA	RHS60*40*4	S235JR	1	700	0.13	4.0	
P/60	TREAPTA	RHS60*40*4	S235JR	2	225	0.04	1.3	
Total						1.23	36.7	

BENEFICIAR: ADMINISTRATIA COMERCIALA SECTOR 6			PROIECT: PIATA VALEA IALOMITEI		
PROIECTANT REZISTENTA: SC LGC CONCEPT DESIGN SRL					
DENUMIRE PLANSĂ: PLAN UZINARE ANSAMBLUL: TR/2					
PROIECTANT: ing. Stefan Neacsu			SCARA: 1:7.5		Nr. Crt. TR/2

Technical drawing of a bookshelf layout. The drawing shows a grid of shelves and vertical supports. Dimensions are provided for the overall size and individual sections.

Overall Dimensions:

- Width: 265 + 760 + 260 + 1025 = 2310
- Height: 350 + 250 + 250 + 240 = 1100

Section Dimensions:

- Section 1 (Left): Width 225, Height 250
- Section 2: Width 720, Height 250
- Section 3: Width 220, Height 250
- Section 4: Width 950, Height 250

Shelf and Support Dimensions:

- Shelf thickness: 40
- Support thickness: 40
- Shelf spacing: 250
- Support spacing: 250

60

P/22

P/22

60

P/22

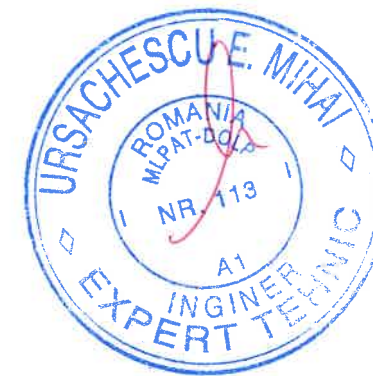

BENEFICIAR:		PROIECT:	
ADMINISTRATIA COMERCIALA SECTOR 6		PIATA VALEA IALOMITEI	
PROIECTANT REZISTENTA: SC LGC CONCEPT DESIGN SRL			
DENUMIRE PLANSĂ:		PLAN UZINARE ANSAMBLUL: TR/4	
PROIECTANT: ing. Stefan Neacsu		SCARA: 1:7.5	
		Nr. Crt. TR/4	

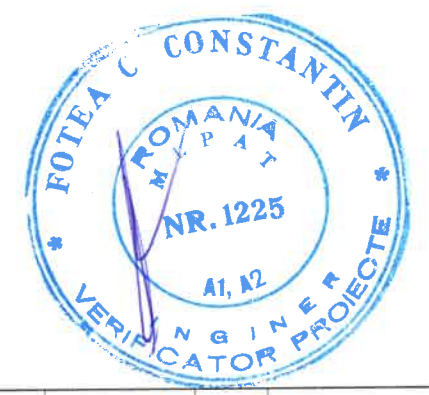
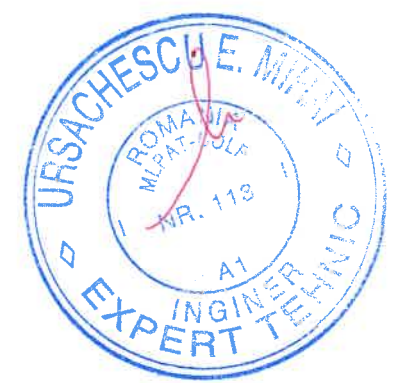
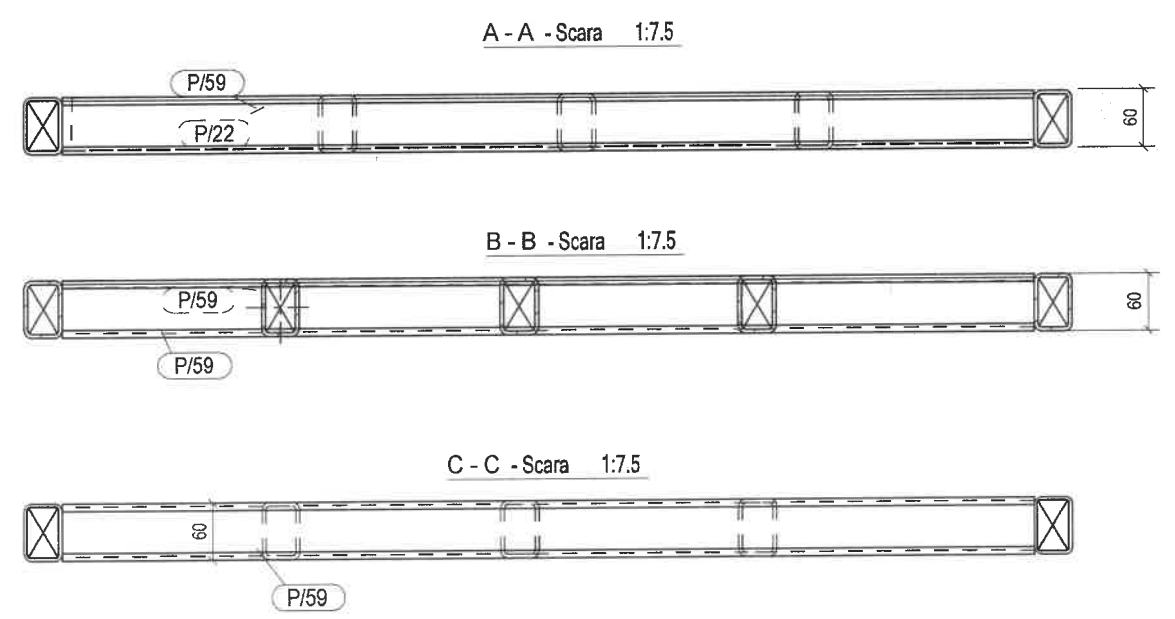
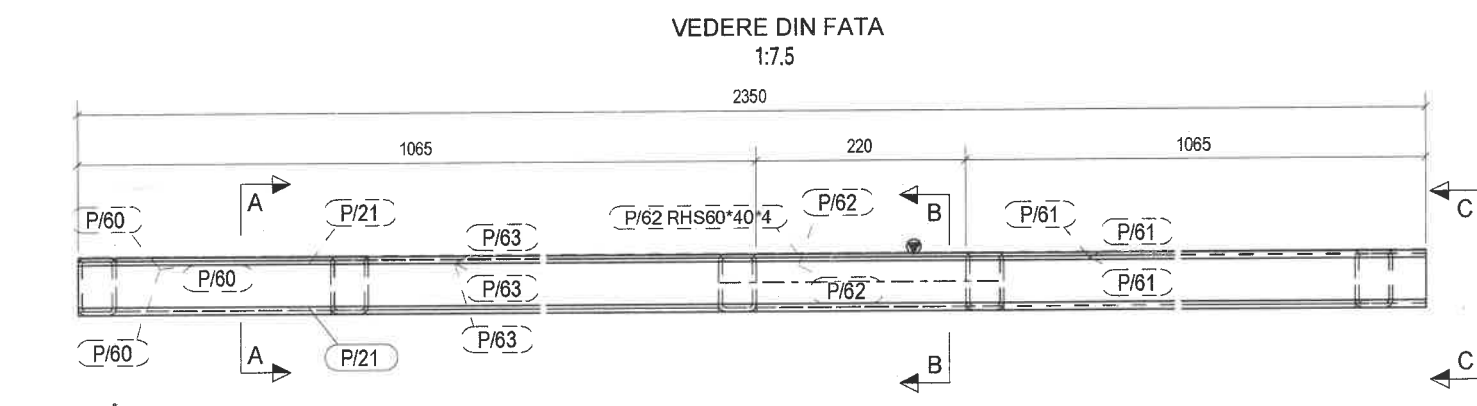
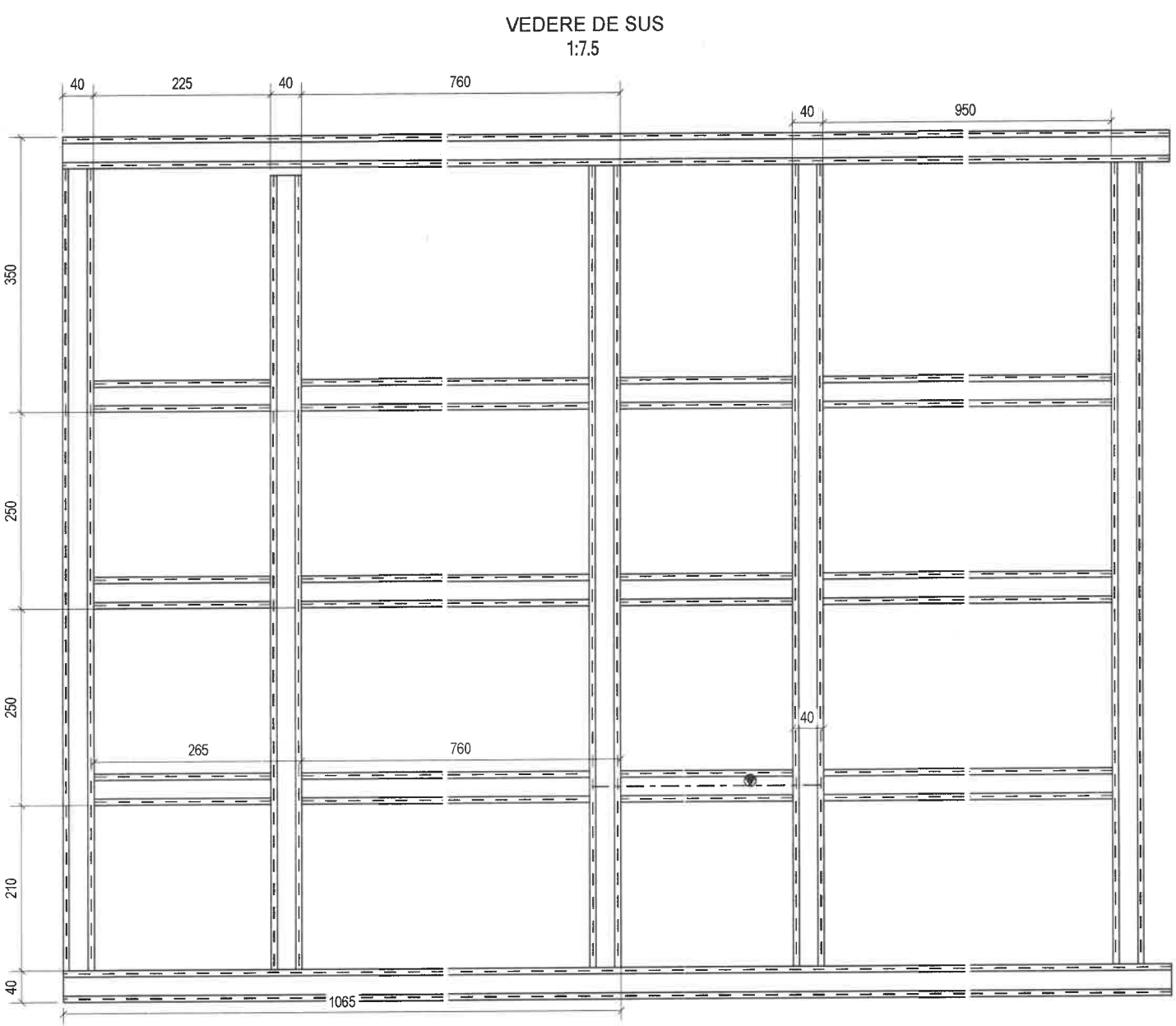

LISTA MATERIALE PENTRU 1 BUC. ANSAMBLUL POZ. TR/5				92.2	kg	1	BUCATI DE EXECUTA	
Pozitia	Denumire	Profil	Material	Bucati	Lungime [mm]	Suprafata [m2]	Masa [kg]	
P/21	TREAPTA	RHS60*40*4	S235JR	2	2350	0.45	13.4	
P/22	TREAPTA	RHS60*40*4	S235JR	1	1010	0.19	5.8	
P/59	TREAPTA	RHS60*40*4	S235JR	4	1020	0.19	5.8	
P/61	TREAPTA	RHS60*40*4	S235JR	3	950	0.18	5.4	
P/63	TREAPTA	RHS60*40*4	S235JR	3	720	0.14	4.1	
P/60	TREAPTA	RHS60*40*4	S235JR	3	225	0.04	1.3	
P/62	TREAPTA	RHS60*40*4	S235JR	3	220	0.04	1.3	
				Total		3.08	92.2	

BENEFICIAR:		PROIECT:	
ADMINISTRATIA COMERCIALA SECTOR 6		PIATA VALEA IALOMITEI	
PROIECTANT REZISTENTA: SC LGC CONCEPT DESIGN SRL			
DENUMIRE PLANSĂ:		PLAN UZINARE ANSAMBLUL: TR/5	
PROIECTANT: ing. Stefan Neacsu		SCARA: 1:7.5	
		Nr. Crt. TR/5	

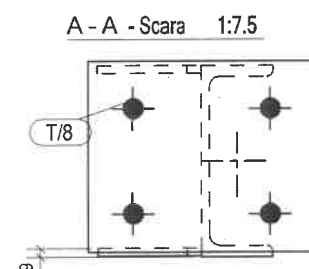
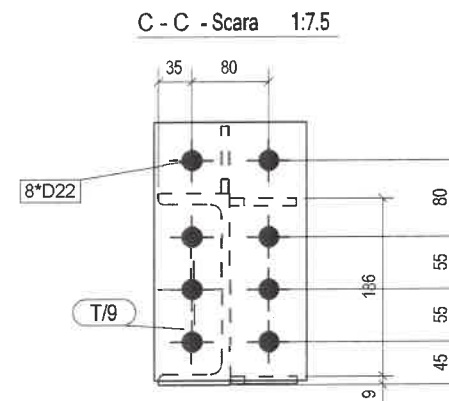
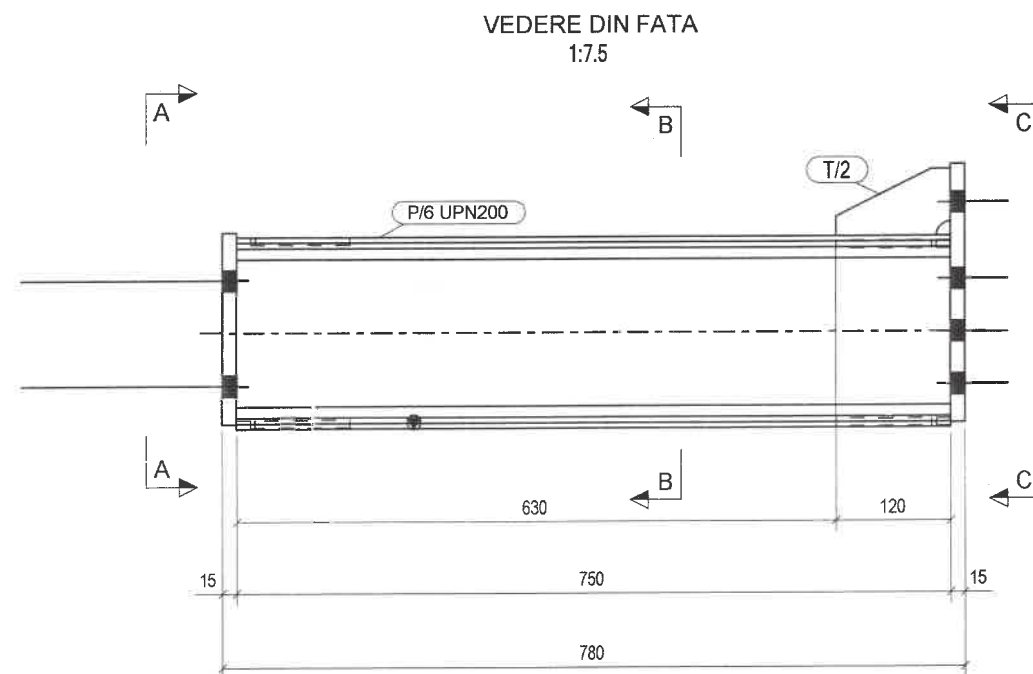
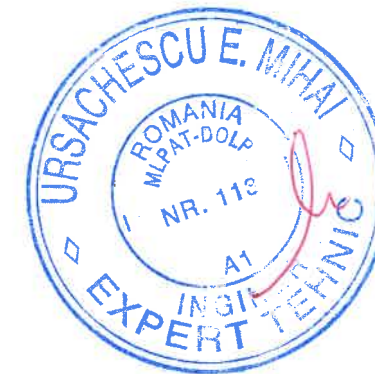
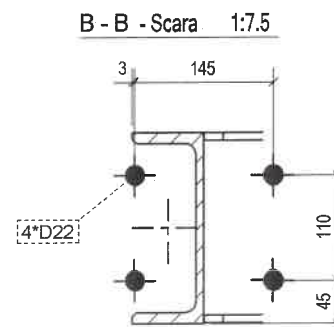
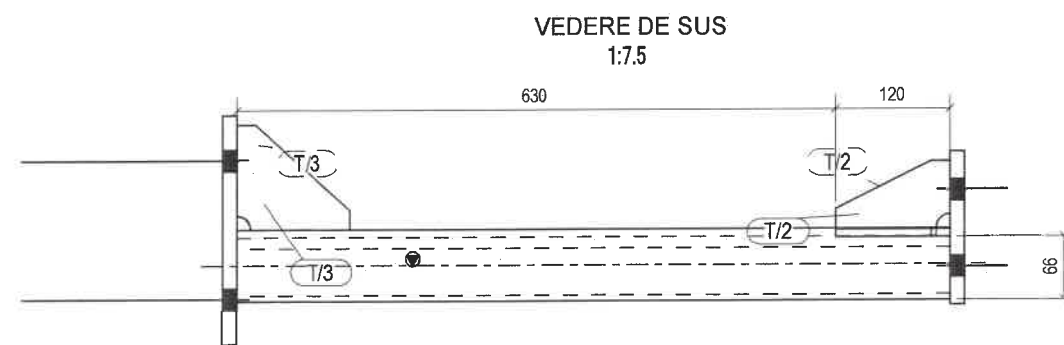

LISTA MATERIALE PENTRU 1 BUC. ANSAMBLUL POZ.			VS/1	31.8	kg	1	BUCATI DE EXECUTA	
Pozitia	Denumire	Profil	Material	Bucati	Lungime [mm]	Suprafata [m2]	Masa [kg]	
P/6	VANG SCARA	UPN200	S235JR	1	750	0.50	19.0	
T/8	PLACA DE CAPAT	PL15*240	S235JR	1	200	0.11	5.7	
T/9	PLACA DE CAPAT	PL15*160	S235JR	1	270	0.10	5.1	
T/3	RIGIDIZARE	PL8*110	S235JR	2	120	0.02	0.5	
T/2	RIGIDIZARE	PL8*70	S235JR	3	120	0.01	0.4	
Total						0.79	31.8	

BENEFICIAR:			PROIECT:	
ADMINISTRATIA COMERCIALA SECTOR 6			PIATA VALEA IALOMITEI	
PROIECTANT REZISTENTA: SC LGC CONCEPT DESIGN SRL				
DENUMIRE PLANSĂ:			PLAN UZINARE ANSAMBLUL: VS/1	
PROIECTANT: ing. Stefan Neacsu			SCARA: 1:7.5	Nr. Crt. VS/1